	Product Information CDM200-4-2A	Manufacturer	CNP
		Address	Yuhang District, Hangzhou, Zhejiang,
		Contact	86-571-88637351
		Date	2022/07/28
Project Name		Client Name	DPA
		Client Addr.	
Item NO		Contacts	Alireza
		Contact	

Part NO.	1100106406
----------	------------

Product Picture	Note
	<p>CDM/CDMF pumps are new generation, high efficiency, non-self-priming vertical multistage centrifugal pumps (Abbr. as pumps). It referred to European standard, adopted entirely new industrial design, efficiency achieved $MEI \geq 0.7$. It is energy saving, low noise, environment friendly, compact design, beautiful shape, light weight, easy for service, high reliability.</p>

Nameplate parameters

flow	200 m ³ /h
head	118 m
Efficiency	77.9
speed	2950
number of stages	4

technology

Pump rotator speed	2950
Nameplate standards	CE
Pump version	2

Material

Impeller	304
Rubber code	P
Inlet&outlet chamber	304
Material Code	S

Installation

Connection Code	F
Maximum Pressure/Temperature	25 bar / 120 °C
Maximum Pressure/Temperature	25 bar / -15 °C
Flange Standard	DIN
Pressure Class	PN25-40
Inlet & outlet	DN150

Medium

Medium Temperature normal	-15°C+70°C
Medium Temperature high t	-15°C+120°C
Maximum Environment Temper	40°C

Motor

Number of Motor Phase	Three Phase
Protection Class	IP55
Insulation Class	F
Motor Power	110KW
Power Frequency	50HZ
Rated Voltage (V)	380V
Rated Current (A)	195A
Energy Efficiency Level	IE3

	Product Information CDM200-4-2A	Manufacturer	CNP
		Address	Yuhang District, Hangzhou, Zhejiang,
		Contact	86-571-88637351
		Date	2022/07/28
Project Name		Client Name	DPA
Item NO		Client Addr.	
		Contacts	Alireza
		Contact	

Seal

Mechanical Seal CDLA-36/WBF14

Others

Weight (kg) 1180





Performance Curve

CDM200-4-2A

Manufacturer	CNP
Address	Yuhang District, Hangzhou, Zhejiang,
Contact	86-571-88637351
Date	2022/07/28
Client Name	DPA
Client Addr.	
Contacts	Alireza
Contact	

Project Name

Item NO

The hydraulic performance curve have been tested with Clean Water at 20°C, density 1000kg/m³, and at 1bar atmospheric pressure. GB32162016 Grande 3B

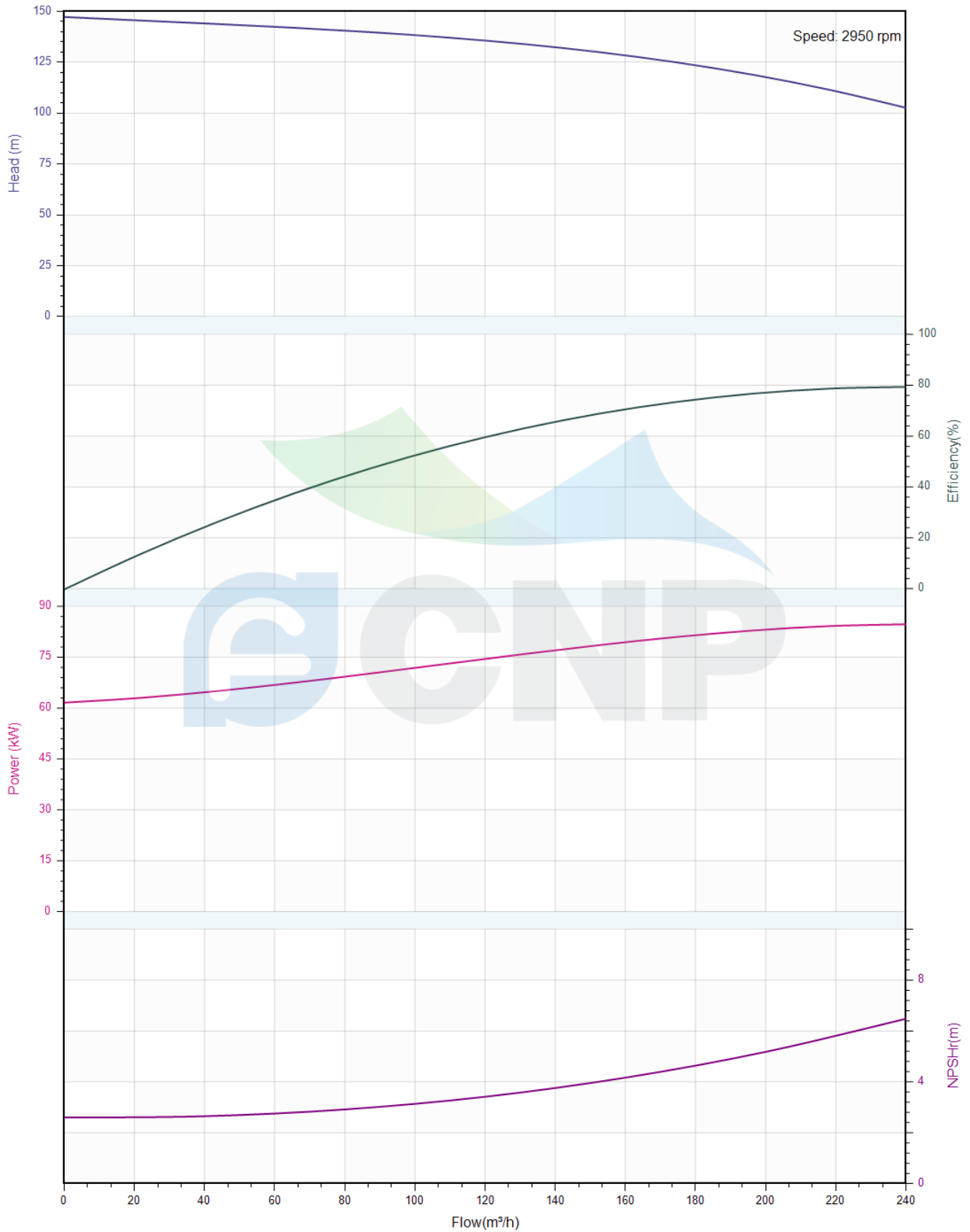



Pump Technical Parameters

CDM200-4-2A

Manufacturer	CNP
Address	Yuhang District, Hangzhou, Zhejiang,
Contact	86-571-88637351
Date	2022/07/28
Client Name	DPA
Client Addr.	
Contacts	Alireza
Contact	

Project Name

Item NO

Rated parameters

Pump model	CDM200-4-2A
Part NO.	1100106406
Rated flow	200 m ³ /h
Rated head	118 m
Rated efficiency (%)	77.9
Power (kW)	79.6
NPSHr (m)	6
Speed (rpm)	2950
Max impeller diameter (mm)	189

Medium

Pumped medium	Clean Water
Working temperature (°C)	20
Medium density (kg/m ³)	1000
Viscosity (mm ² /s)	1

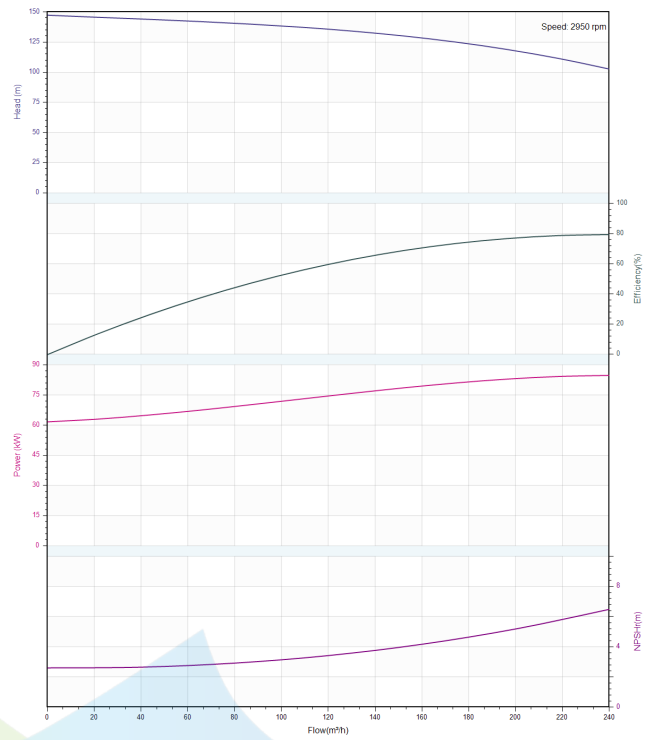



Structure picture
CDM200-4-2A

Manufacturer	CNP
Address	Yuhang District, Hangzhou, Zhejiang,
Contact	86-571-88637351
Date	2022/07/28
Client Name	DPA
Client Addr.	
Contacts	Alireza
Contact	

Project Name

Item NO

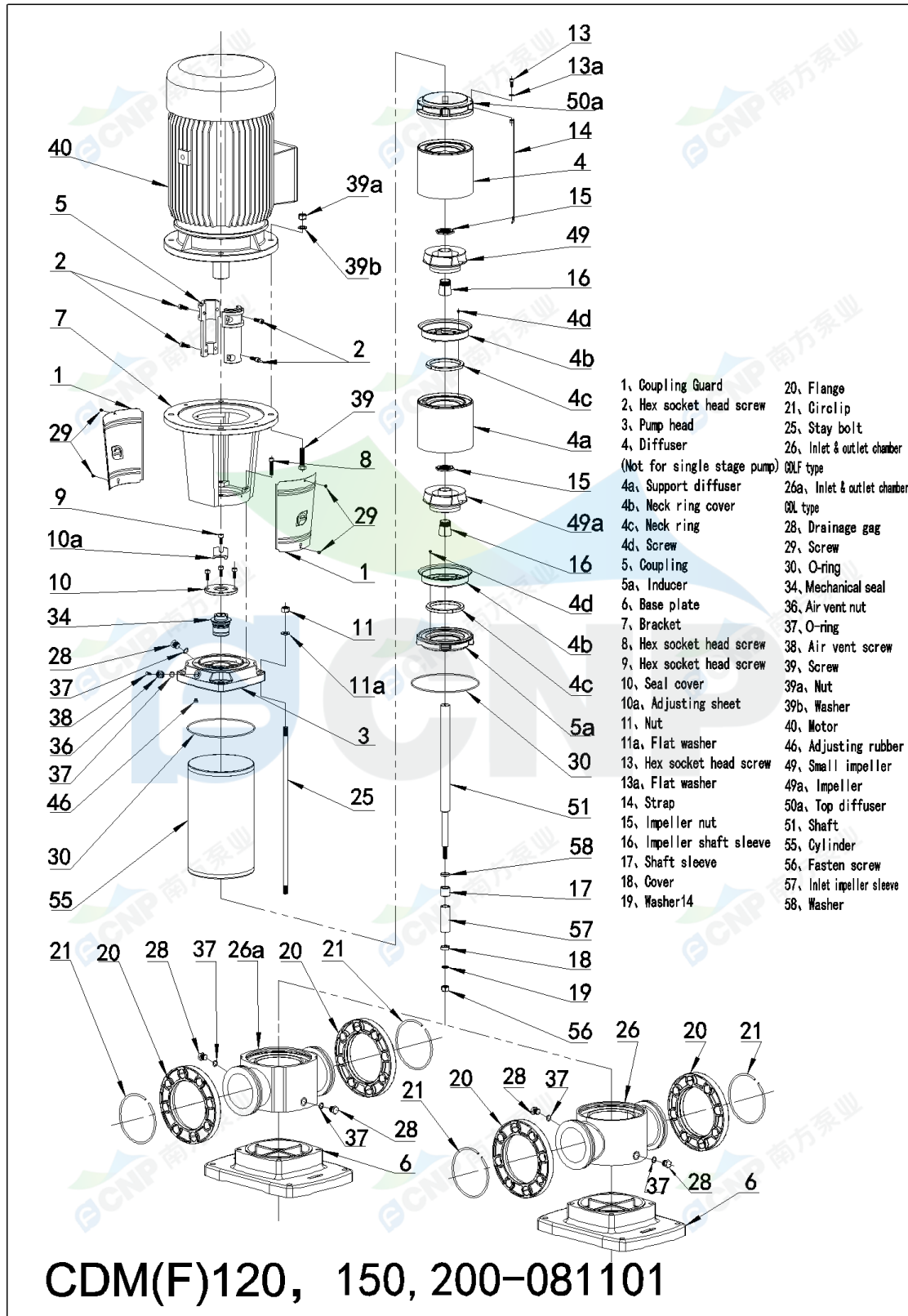



Physical picture
CDM200-4-2A

Manufacturer	CNP
Address	Yuhang District, Hangzhou, Zhejiang,
Contact	86-571-88637351
Date	2022/07/28
Client Name	DPA
Client Addr.	
Contacts	Alireza
Contact	

Project Name

Item NO

