



|  |  |              |                            |
|--|--|--------------|----------------------------|
|  | <b>Product information</b><br><b>65WQ30-60-15(I)</b> | Manufacturer | CNP                        |
|  |  | Address      | Yuhang District, Hangzhou, |
| <b>Project Name</b>  |  | Contact      | 86-571-88637351            |
|  |  | Date         | 2022/03/09                 |
| <b>Station Number</b>  |  | Client Name  | DPA                        |
|  |  | Client Addr. |                            |
|  |  | Contacts     | Alireza                    |
|  |  | Contact      |                            |

|   |  |
|---|--|
| Product No.   | 65WQ30-60-15(I)  |
| Product picture(Note:the picture may not be the same as the                       | Series description   |
|  | Single channel or double channel impeller.Auto-coupling system on request. |

|                               |             |
|-------------------------------|-------------|
| <b>Performance Data</b>       |             |
| Rated flow(m <sup>3</sup> /h) | 30          |
| Rated head(m)                 | 60          |
| Efficiency(%)                 | 44.3        |
| Rated power(kW)(kW)           | 9.713       |
| Rate Speed(rpm)               | 2930        |
| <b>technology</b>             |             |
| Pump rotator speed            | 2930        |
| Nameplate standards           | CE          |
| <b>Material</b>               |             |
| Impeller                      | HT200       |
| Pump shaft                    | 20cr13      |
| Rubber code                   | P           |
| Pump case                     | HT200       |
| <b>Installation</b>           |             |
| Connection Code               | F           |
| Maximum Pressure/Temperatu    | 6bar/40     |
| Flange Standard               | DIN         |
| Pressure Class                | PN6         |
| <b>Medium</b>                 |             |
| Medium Temperature            | 40          |
| Maximum diameter of partic    | 22          |
| Maximum Environment Temper    | 40          |
| <b>Structure dimension</b>    |             |
| Standard                      | DN          |
| Outlet size                   | DN65        |
| <b>Motor</b>                  |             |
| Number of Motor Phase         | Three Phase |
| Protection Class              | IP68        |
| Insulation Class              | F           |
| Motor Power                   | 15          |
| Power Frequency               | 50HZ        |
| Rated Voltage (V)             | 380V        |
| Rated Current (A)             | 22          |

|  |  |              |                            |
|--|--|--------------|----------------------------|
|  | <b>Product information</b><br><b>65WQ30-60-15(I)</b> | Manufacturer | CNP                        |
|  |  | Address      | Yuhang District, Hangzhou, |
|  |  | Contact      | 86-571-88637351            |
|  |  | Date         | 2022/03/09                 |
| <b>Project Name</b>  |  | Client Name  | DPA                        |
|  |  | Client Addr. |                            |
| <b>Station Number</b>  |  | Contacts     | Alireza                    |
|  |  | Contact      |                            |

Starting mode                      direct boot

**Seal**

Mechanical Seal                      H-30

**Others**

Weight (kg)                              95





# Performance Curve 65WQ30-60-15(I)

|              |                            |
|--------------|----------------------------|
| Manufacturer | CNP                        |
| Address      | Yuhang District, Hangzhou, |
| Contact      | 86-571-88637351            |
| Date         | 2022/03/09                 |
| Client Name  | DPA                        |
| Client Addr. |                            |
| Contacts     | Alireza                    |
| Contact      |                            |

Project Name

Station Number

Medium Name Clear Water , Temperature 20°C, Density 1000kg/m<sup>3</sup>, Viscosity 1mm<sup>2</sup>/s, (ISO99062012 Grande 3B)

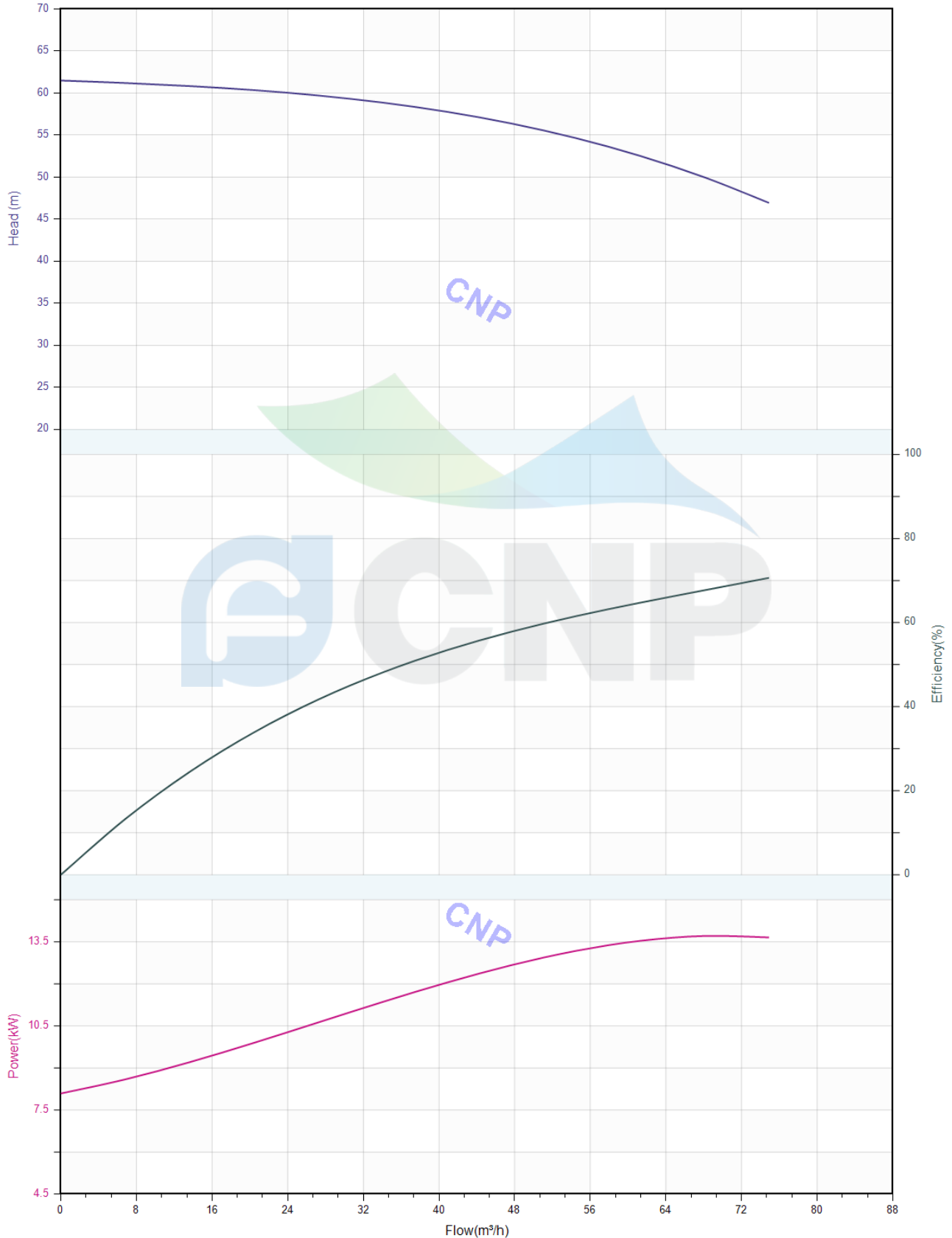

|  |  |              |                            |
|--|--|--------------|----------------------------|
|  | <b>Pump technical parameters</b><br><b>65WQ30-60-15(I)</b> | Manufacturer | CNP                        |
|  |  | Address      | Yuhang District, Hangzhou, |
| Project Name   |  | Contact      | 86-571-88637351            |
|  |  | Date         | 2022/03/09                 |
| Station Number   |  | Client Name  | DPA                        |
|  |  | Client Addr. |                            |
|  |  | Contacts     | Alireza                    |
|  |  | Contact      |                            |

| Rated parameters              |                 |
|-------------------------------|-----------------|
| Pump model                    | 65WQ30-60-15(I) |
| Product No.                   | 65WQ30-60-15(I) |
| Rated flow(m <sup>3</sup> /h) | 30              |
| Rated pressure(m)             | 60              |
| Rated efficiency(%)           | 44.3            |
| Power(kW)                     | 9.713           |
| Speed(rpm)                    | 2930            |

| Medium                             |             |
|------------------------------------|-------------|
| Medium Name                        | Clear Water |
| Working temperature(°C)            | 20          |
| Medium density(kg/m <sup>3</sup> ) | 1000        |
| Viscosity(mm <sup>2</sup> /s)      | 1           |

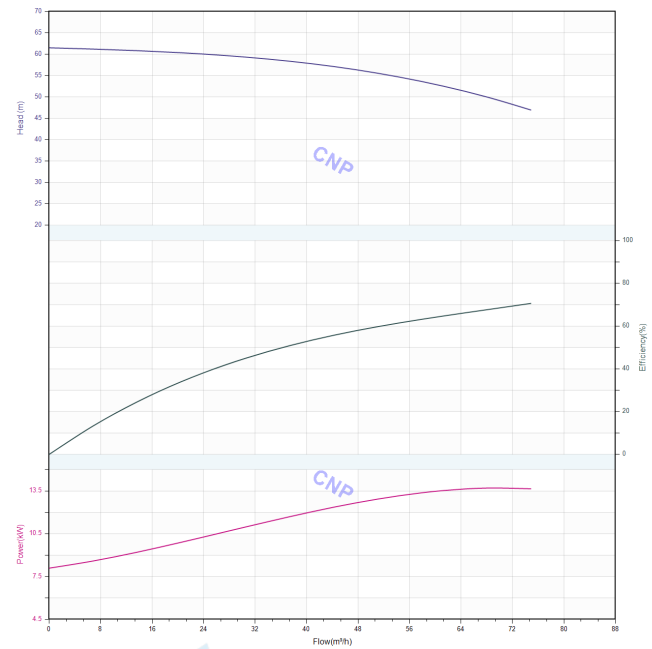

|  |  |              |                            |
|--|--|--------------|----------------------------|
|  | <b>Structure picture</b><br><b>65WQ30-60-15(I)</b> | Manufacturer | CNP                        |
|  |  | Address      | Yuhang District, Hangzhou, |
| Project Name   |  | Contact      | 86-571-88637351            |
|  |  | Date         | 2022/03/09                 |
| Station Number   |  | Client Name  | DPA                        |
|  |  | Client Addr. |                            |
|  |  | Contacts     | Alireza                    |
|  |  | Contact      |                            |

## CNP Nanfang Zhongjin Environment Co., Ltd.

|      |                          |       |            |
|------|--------------------------|-------|------------|
|      | <b>SECTIONAL DRAWING</b> | No.   | No.        |
| TYPE | submersible sewage pump  | MODEL | WQ-11/15kW |

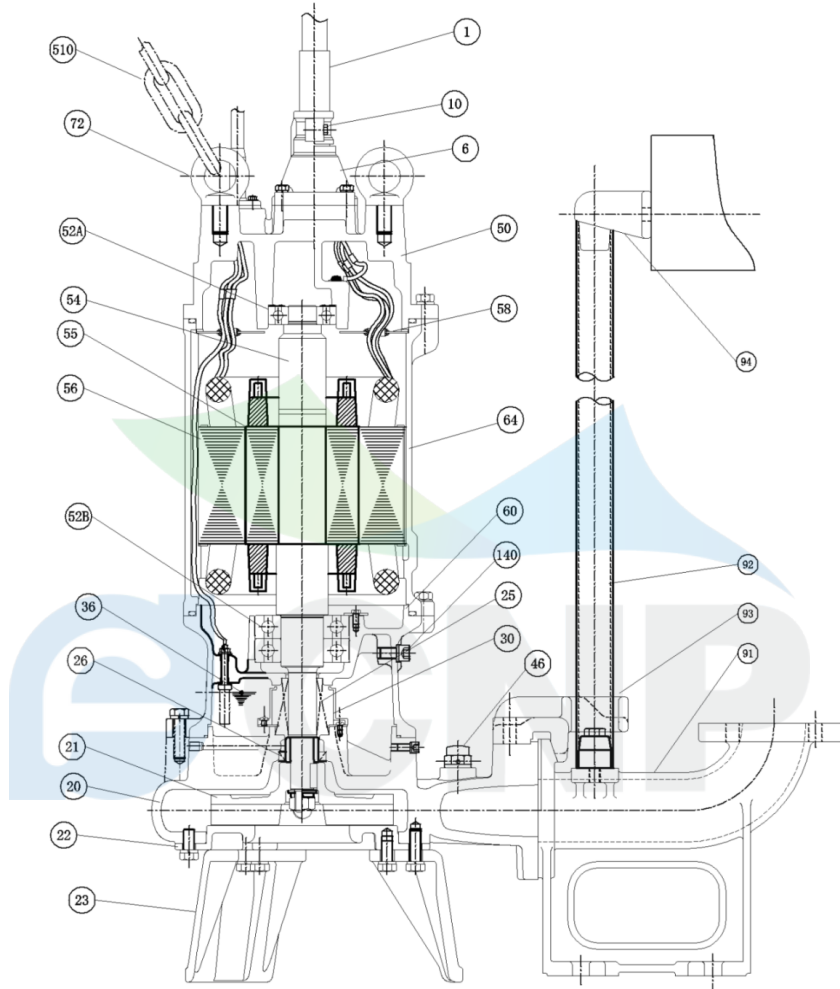

| order specifications |                     |        |                      |     |                    |        |                         |
|----------------------|---------------------|--------|----------------------|-----|--------------------|--------|-------------------------|
| No.                  | names of parts      | number | material             | No. | names of parts     | number | material                |
| 1                    | cable               | 1      | YZW                  | 20  | casing             | 1      | HT200                   |
| 6                    | cable sleeve        | 1      | HT200                | 21  | impeller           | 1      | HT200                   |
| 50                   | top cover           | 1      | HT200                | 26  | framework oil seal | 1      | NBR-2                   |
| 58                   | cable transit board | 1      | Q235                 | 140 | oil filler plug    | 2      | SUS304                  |
| 64                   | base                | 1      | HT200                | 36  | machine oil 32#    |        |                         |
| 25                   | mechanical seal     | 1      | Carbon/SIC           | 52B | lower bearing      | 2      |                         |
| 60                   | lower cover         | 1      | HT200                | 56  | stator             | 1      |                         |
| 30                   | oil lift            | 1      |                      | 55  | rotor              | 1      |                         |
| 46                   | Air release bolt    | 1      |                      | 54  | shaft              | 1      |                         |
| 94                   | guiding             | 1      | HT200                | 52A | upper bearing      | 1      |                         |
| 92                   | pipe                | 1      | SUS304(unaffiliated) | 72  | eye bolt           | 2      | SUS304                  |
| 93                   | guide hook          | 1      | HT200                | 510 | lift chain         | 1      | 45#(forging galvanized) |
| 91                   | water outlet base   | 1      | HT200                | 23  | foot bracket       | 3      | HT200                   |
| 22                   | water inlet cover   | 1      | HT200                | 10  | Cable lockblock    | 2      | HT200                   |

Nanfang Zhongjin Environment CO.,LTD.

unit : mm



## Installation picture 65WQ30-60-15(I)

|              |                            |
|--------------|----------------------------|
| Manufacturer | CNP                        |
| Address      | Yuhang District, Hangzhou, |
| Contact      | 86-571-88637351            |
| Date         | 2022/03/09                 |
| Client Name  | DPA                        |
| Client Addr. |                            |
| Contacts     | Alireza                    |
| Contact      |                            |

Project Name

Station Number

**CNP Nanfang Zhongjin Environment Co., Ltd.**

|                              |  |       |              |
|------------------------------|--|-------|--------------|
| DIMENSION DRAWING            |  | No.   | No.          |
| TYPE submersible sewage pump |  | MODEL | 65WQ50-55-15 |

| MODEL        | d  | A   | A1  | A2  | A3  | A4  | A5  | B   | B1  | D   | D1  | W1  | W2  | H   | Body weight |
|--------------|----|-----|-----|-----|-----|-----|-----|-----|-----|-----|-----|-----|-----|-----|-------------|
| 65WQ50-55-15 | 65 | 462 | 539 | 142 | 220 | 288 | 317 | 311 | 311 | 345 | 175 | 630 | 380 | 916 | 96kg        |

|              |       |
|--------------|-------|
| diameter     | 65    |
| elbow weight | 3.0kg |
| head weight  | 5.5kg |

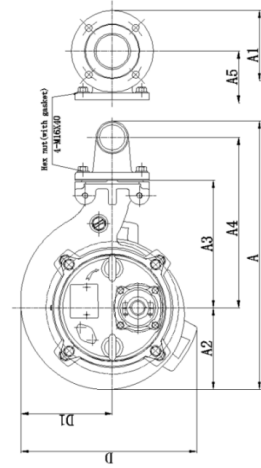
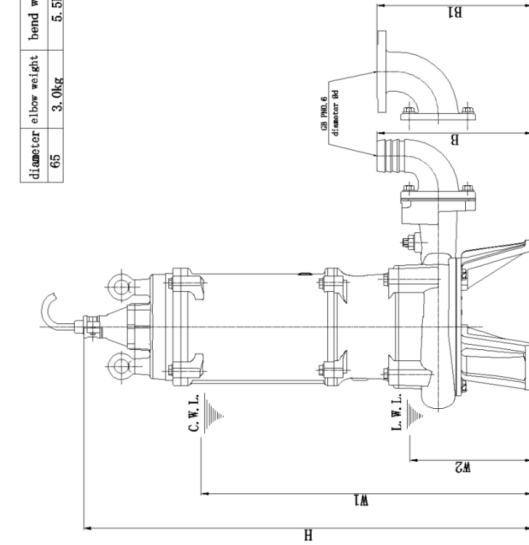

C.W.L. : minimum water level under continuous operation  
L.W.L. : minimum water level under possible operation

unit: mm

Nanfang Zhongjin Environment Co., LTD.

**CNP Nanfang Zhongjin Environment Co., Ltd.**

|                              |  |       |              |
|------------------------------|--|-------|--------------|
| DIMENSION DRAWING            |  | No.   | No.          |
| TYPE submersible sewage pump |  | MODEL | 65WQ30-60-15 |

| MODEL           | A   | A1  | A2  | A3  | A4  | B   | D1  | D   | H1         | H2   | H   | W1  | W2  | H    | Body weight |    |     |     |    |                |
|-----------------|-----|-----|-----|-----|-----|-----|-----|-----|------------|------|-----|-----|-----|------|-------------|----|-----|-----|----|----------------|
| 65WQ30-60-15    | 142 | 340 | 130 | 210 | 280 | 289 | 151 | 630 | 599        | 1299 | 125 | 596 | 350 | 1299 | 95kg        |    |     |     |    |                |
| Outlet diameter | d   | T1  | T2  | T3  | T4  | T5  | T6  | T7  | T8         | T9   | T10 | K1  | K2  | K3   | K4          | K5 | B1  | B2  | B3 | Comline weight |
| 65WQ30-60-15    | 65  | 200 | 195 | 80  | 50  | 60  | 190 | 220 | 1.37/426.6 | 31   | 25  | 140 | 140 | 40   | 105         | 15 | 268 | 220 | 15 | 18kg           |

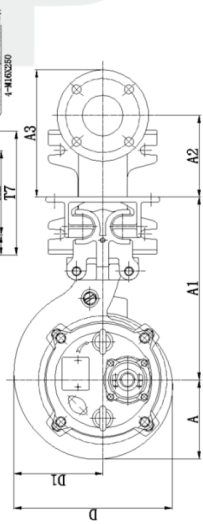
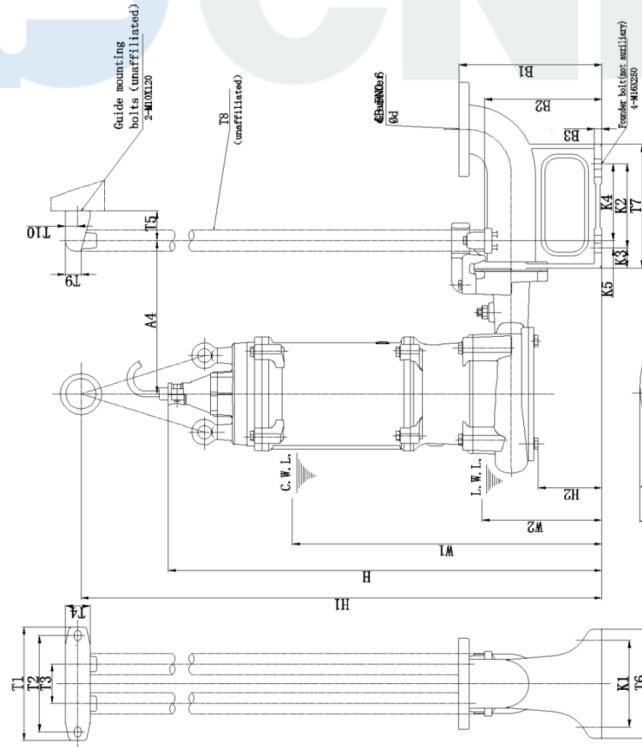

C.W.L. : minimum water level under continuous operation  
L.W.L. : minimum water level under possible operation

unit: mm

Nanfang Zhongjin Environment Co., LTD.