	Product Information CHM12-1	Manufacturer	CNP
		Address	Yuhang District, Hangzhou, Zhejiang,
Project Name		Contact	86-571-88637351
		Date	2022/03/07
Item NO		Client Name	DPA
		Client Addr.	
		Contacts	Alireza
		Contact	

Part NO.	1100082722
----------	------------

Product Picture	Note
	<p>Non-self-priming horizontal multistage centrifugal pump. The impeller guide vane is made of stainless steel plate stamping and welding. Equipped with long shaft motor, axial inlet and radial outlet.</p>

technology	
Pump rotator speed	2900
Material	
Impeller	304
Rubber code	F
Material Code	S
Installation	
Connection Code	L
Installation type	horizontal
Maximum Operation Pressure	10Bar
Medium	
Medium Temperature normal	-15+70
Medium Temperature high t	-15+105
Maximum Environment Temper	40
Structure dimension	
Inlet & outlet size types	G
Inlet & Outlet Diameter	G1½/G1½
Rotation Direction	Clockwise
Motor	
Number of Motor Phase	Three Phase
Protection Class	IP55
Insulation Class	F
Motor Power	0.75
Energy Efficiency Level	IE2
Seal	
Mechanical Seal	CHM-19/SB1F4
Others	
Weight (kg)	14



Performance Curve CHM12-1

Manufacturer	CNP
Address	Yuhang District, Hangzhou, Zhejiang,
Contact	86-571-88637351
Date	2022/03/07
Client Name	DPA
Client Addr.	
Contacts	Alireza
Contact	

Project Name

Item NO

The hydraulic performance curve have been tested with Clean Water at 20°C, density 1000kg/m³, and at 1bar atmospheric pressure. ISO99062012 Grade 3B

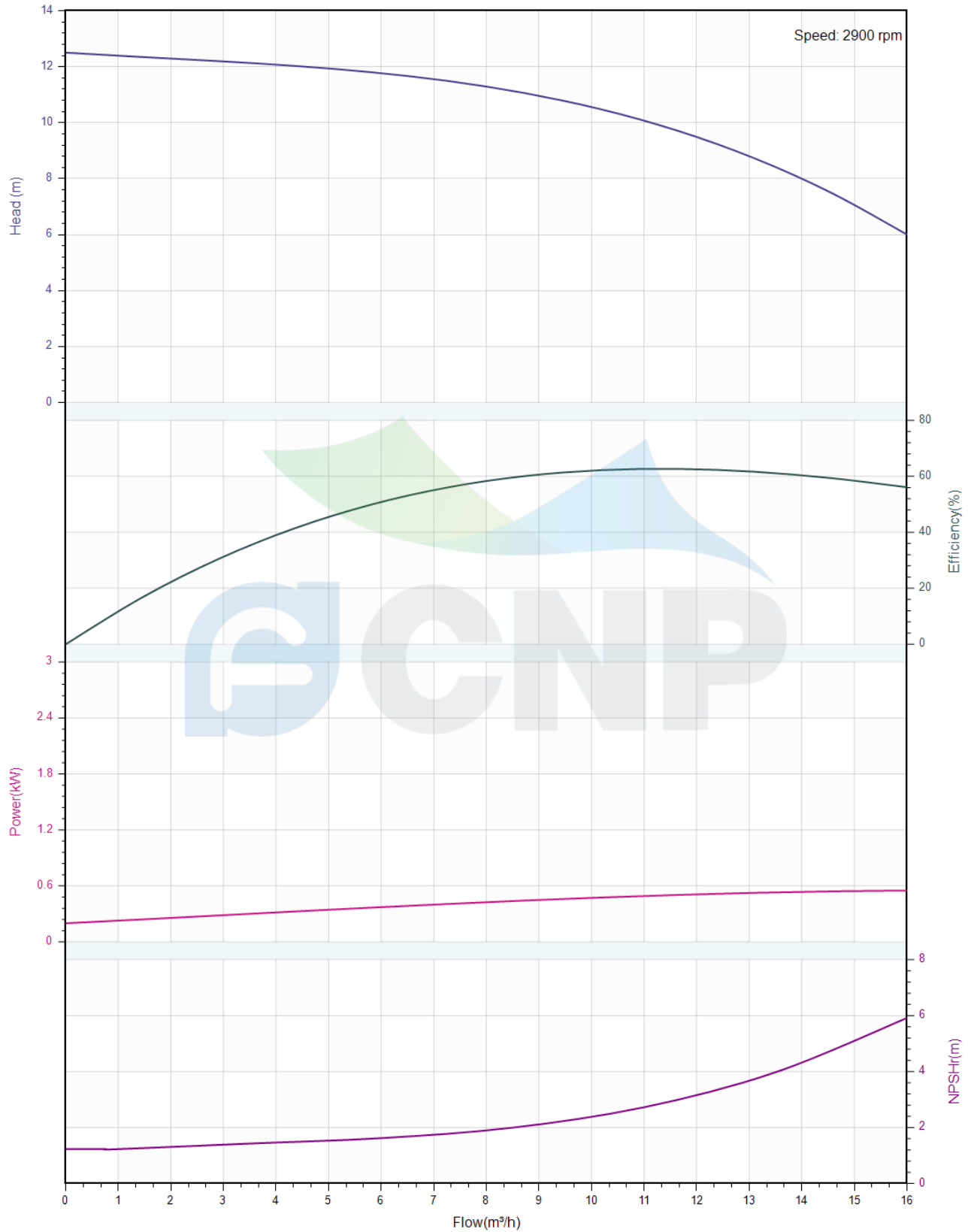



Pump Technical Parameters CHM12-1

Manufacturer	CNP
Address	Yuhang District, Hangzhou, Zhejiang,
Contact	86-571-88637351
Date	2022/03/07
Client Name	DPA
Client Addr.	
Contacts	Alireza
Contact	

Rated parameters

Pump model	CHM12-1
Part NO.	1100082722
Rated flow (m ³ /h)	12
Rated head (m)	9.5
Rated efficiency (%)	60
Power (kW)	0.518
NPSHr (m)	2.5
Speed (rpm)	2900
Max impeller diameter (mm)	105

Medium

Pumped medium	Clean Water
Working temperature (°C)	20
Medium density (kg/m ³)	1000
Viscosity (mm ² /s)	1

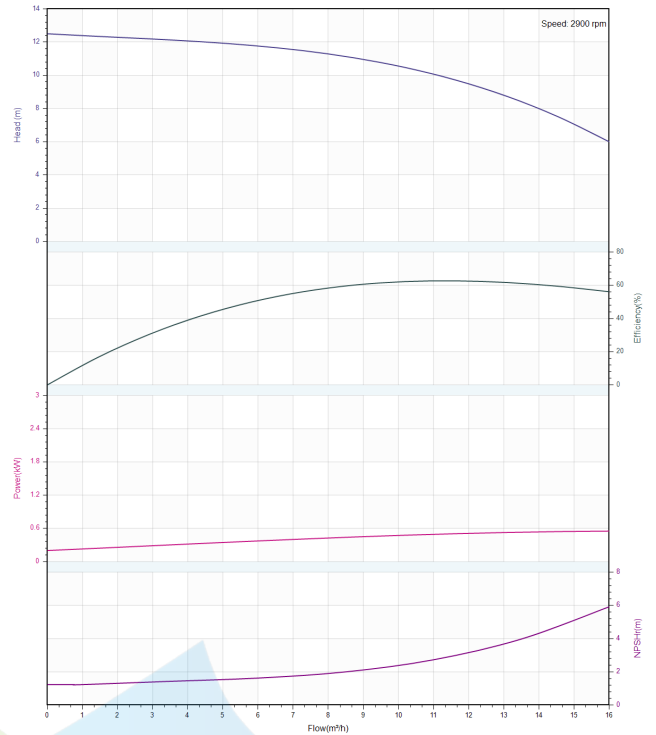

	Structure picture CHM12-1	Manufacturer	CNP
		Address	Yuhang District, Hangzhou, Zhejiang,
Project Name		Contact	86-571-88637351
		Date	2022/03/07
Item NO		Client Name	DPA
		Client Addr.	
		Contacts	Alireza
		Contact	

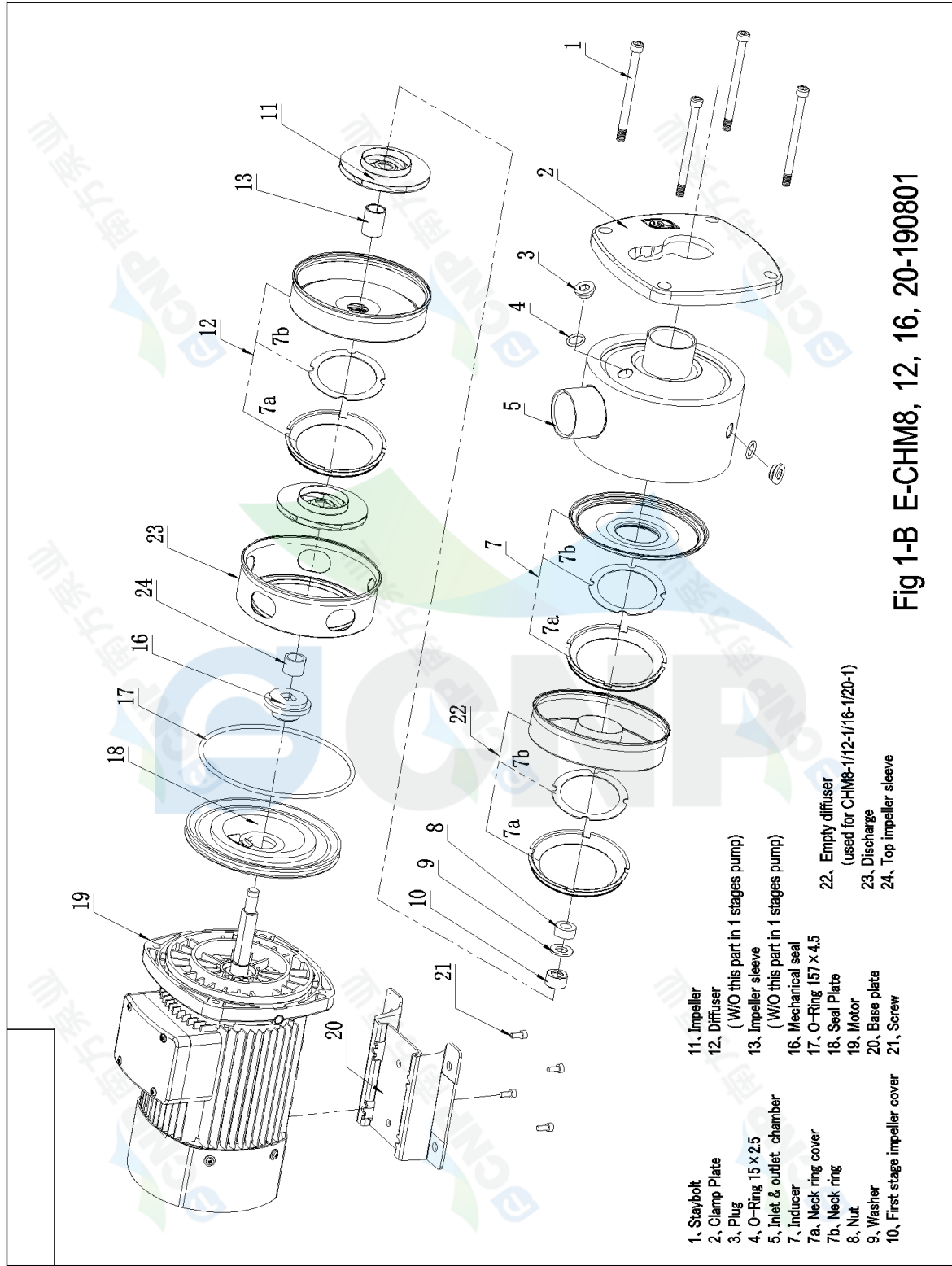

Fig 1-B E-CHM8, 12, 16, 20-190801

- | | |
|--------------------------------|----------------------------------|
| 1, Staybolt | 11, Impeller |
| 2, Clamp Plate | 12, Diffuser |
| 3, Plug | (W/O this part in 1 stages pump) |
| 4, O-Ring 15 x 2.5 | 13, Impeller sleeve |
| 5, Inlet & outlet chamber | (W/O this part in 1 stages pump) |
| 7, Inducer | 16, Mechanical seal |
| 7a, Neck ring cover | 17, O-Ring 157 x 4.5 |
| 7b, Neck ring | 18, Seal Plate |
| 8, Nut | 19, Motor |
| 9, Washer | 20, Base plate |
| 10, First stage impeller cover | 21, Screw |
| | 22, Empty diffuser |
| | (used for CHM8-1/12-1/16-1/20-1) |
| | 23, Discharge |
| | 24, Top impeller sleeve |

描 图
描 校
旧底图总号
底 图 总 号
签 字
日 期

