



|  |   |              |                                      |
|--|---|--------------|--------------------------------------|
|  | <b>Product Information</b><br><br><b>CHLF8-50</b> | Manufacturer | CNP                                  |
|  |   | Address      | Yuhang District, Hangzhou, Zhejiang, |
| Project Name   |   | Contact      | 86-571-88637351                      |
|  |   | Date         | 2022/03/06                           |
| Item NO  |   | Client Name  | DPA                                  |
|  |   | Client Addr. |                                      |
|  |   | Contacts     | Alireza                              |
|  |   | Contact      |                                      |

|          |            |
|----------|------------|
| Part NO. | 1100048899 |
|----------|------------|

| Product Picture   | Note   |
|---|--|
|  | <p>Product introduction</p> <p>Horizontal multistage non-self-priming centrifugal pump with close coupling motor; Impellers and diffusers are made of stainless steel plate with stamping and welding technology; Axial inlet and radial outlet.</p> <p>Performance and advantages</p> <p>Compact structure<br/>Low noise<br/>Suitable for slightly corrosive liquid<br/>Small installation space</p> <p>Application</p> |

### technology

|                    |      |
|--------------------|------|
| Pump rotator speed | 2900 |
| Pump version       | 2    |

### Material

|               |     |
|---------------|-----|
| Impeller      | 304 |
| Rubber code   | P   |
| Material Code | S   |

### Installation

|                             |            |
|-----------------------------|------------|
| Connection Code             | L          |
| Installation type           | horizontal |
| Maximum Pressure/Temperatur | 10 bar     |
| Maximum Pressure/Temperatur | 10 bar     |

### Medium

|                            |         |
|----------------------------|---------|
| Medium Temperature normal  | -15+70  |
| Medium Temperature high t  | -15+105 |
| Maximum Environment Temper | 40      |

### Structure dimension

|                    |           |
|--------------------|-----------|
| Inlet Bore         | G1 1/2    |
| Outlet Diameter    | G1 1/4    |
| Rotation Direction | Clockwise |

### Motor

|                         |             |
|-------------------------|-------------|
| Number of Motor Phase   | Three Phase |
| Protection Class        | IP55        |
| Insulation Class        | F           |
| Motor Power             | 2.2         |
| Power Frequency         | 50          |
| Rated Voltage (V)       | 380V        |
| Energy Efficiency Level | IE2         |

### Seal

|                 |             |
|-----------------|-------------|
| Mechanical Seal | CHL-20/BSF4 |
|-----------------|-------------|

### Others

|             |    |
|-------------|----|
| Weight (kg) | 25 |
|-------------|----|



# Performance Curve CHLF8-50

|              |                                      |
|--------------|--------------------------------------|
| Manufacturer | CNP                                  |
| Address      | Yuhang District, Hangzhou, Zhejiang, |
| Contact      | 86-571-88637351                      |
| Date         | 2022/03/06                           |
| Client Name  | DPA                                  |
| Client Addr. |                                      |
| Contacts     | Alireza                              |
| Contact      |                                      |

Project Name

Item NO

The hydraulic performance curve have been tested with Clean Water at 20°C, density 1000kg/m<sup>3</sup>, and at 1bar atmospheric pressure. ISO99062012 Grade 3B

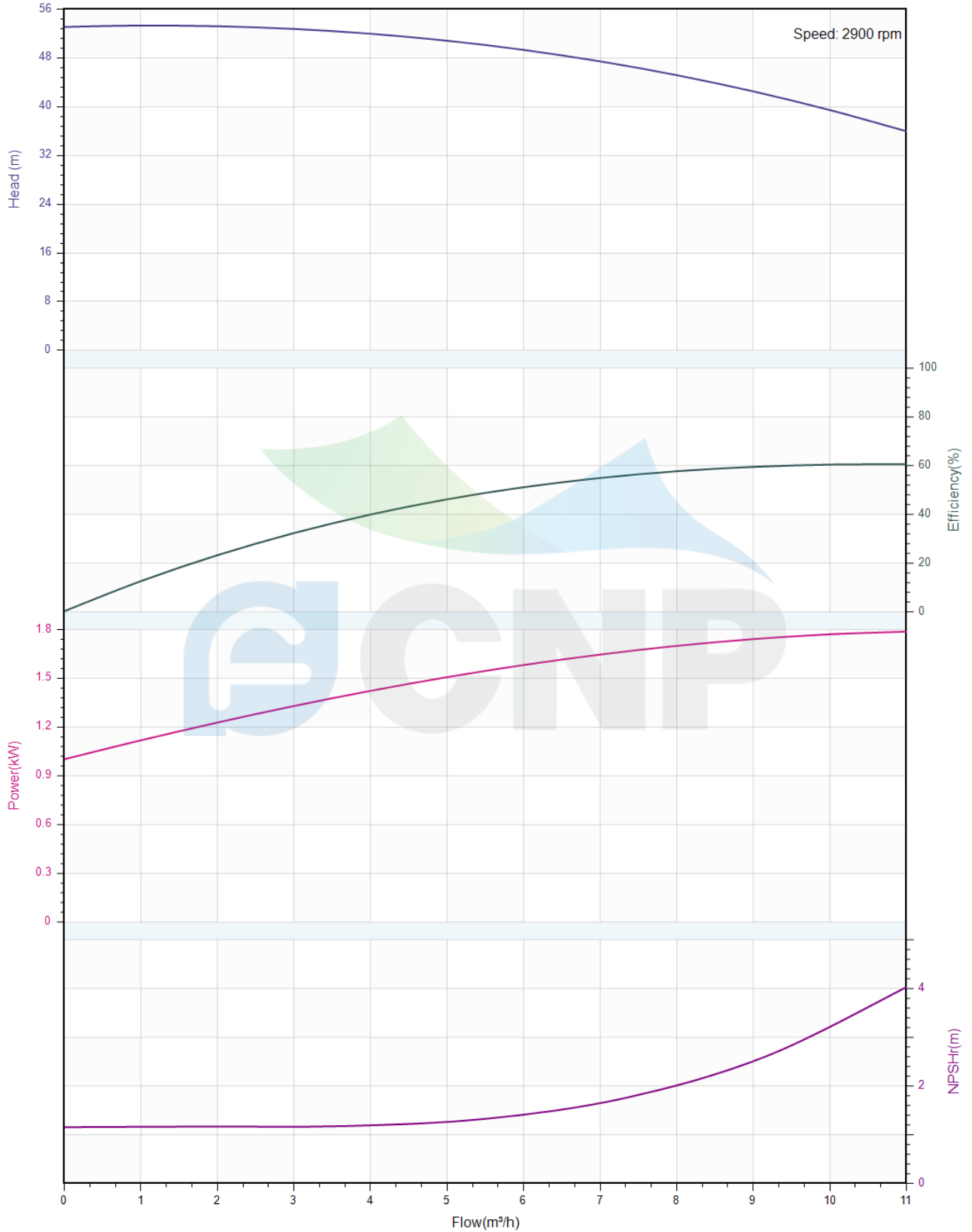

|  |   |              |                                      |
|--|---|--------------|--------------------------------------|
|  | <b>Pump Technical Parameters</b><br><b>CHLF8-50</b> | Manufacturer | CNP                                  |
|  |   | Address      | Yuhang District, Hangzhou, Zhejiang, |
| Project Name   |   | Contact      | 86-571-88637351                      |
|  |   | Date         | 2022/03/06                           |
| Item NO  |   | Client Name  | DPA                                  |
|  |   | Client Addr. |                                      |
|  |   | Contacts     | Alireza                              |
|  |   | Contact      |                                      |

| Rated parameters                    |             |
|-------------------------------------|-------------|
| Pump model                          | CHLF8-50    |
| Part NO.                            | 1100048899  |
| Rated flow (m <sup>3</sup> /h)      | 8           |
| Rated head (m)                      | 45          |
| Rated efficiency (%)                | 57          |
| Power (kW)                          | 1.72        |
| NPSHr (m)                           | 2           |
| Speed (rpm)                         | 2900        |
| Max impeller diameter (mm)          | 96.5        |
| Medium                              |             |
| Pumped medium                       | Clean Water |
| Working temperature (°C)            | 20          |
| Medium density (kg/m <sup>3</sup> ) | 1000        |
| Viscosity (mm <sup>2</sup> /s)      | 1           |

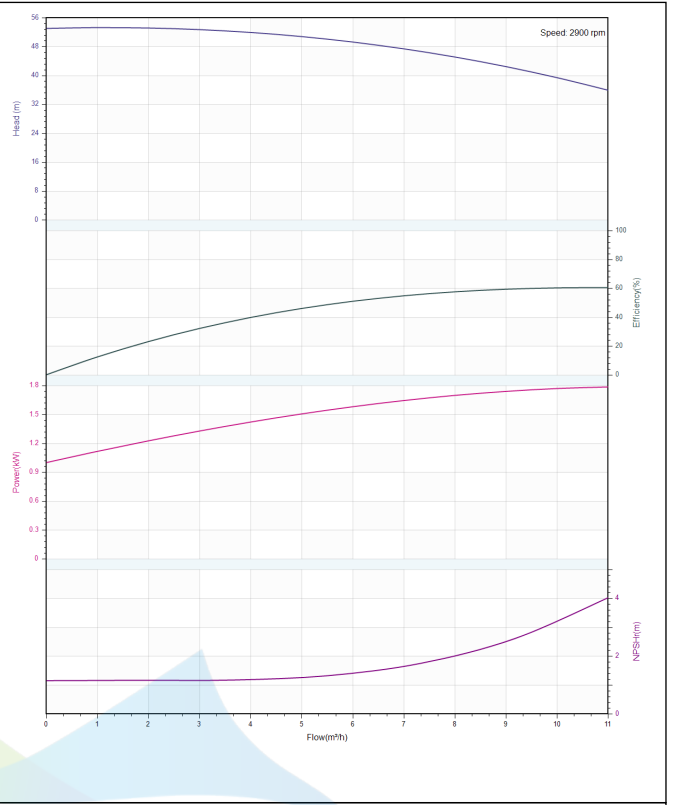



**Structure picture**  
**CHLF8-50**

|              |                                      |
|--------------|--------------------------------------|
| Manufacturer | CNP                                  |
| Address      | Yuhang District, Hangzhou, Zhejiang, |
| Contact      | 86-571-88637351                      |
| Date         | 2022/03/06                           |
| Client Name  | DPA                                  |
| Client Addr. |                                      |
| Contacts     | Alireza                              |
| Contact      |                                      |

Project Name

Item NO

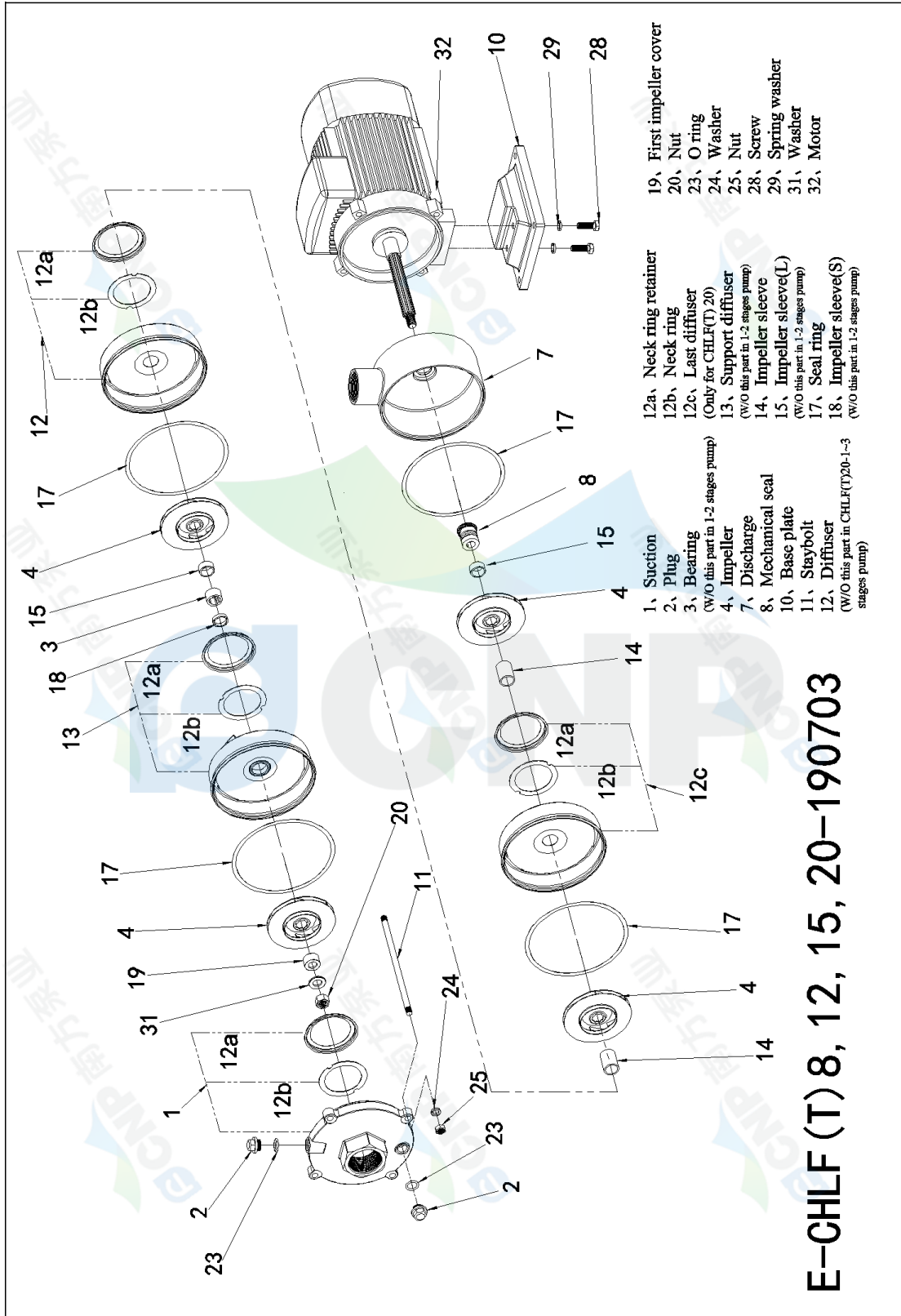

**E-CHLF(T) 8, 12, 15, 20-190703**



### Dimension Drawing CHLF8-50

|              |                                      |
|--------------|--------------------------------------|
| Manufacturer | CNP                                  |
| Address      | Yuhang District, Hangzhou, Zhejiang, |
| Contact      | 86-571-88637351                      |
| Date         | 2022/03/06                           |
| Client Name  | DPA                                  |
| Client Addr. |                                      |
| Contacts     | Alireza                              |
| Contact      |                                      |

Project Name

Item NO

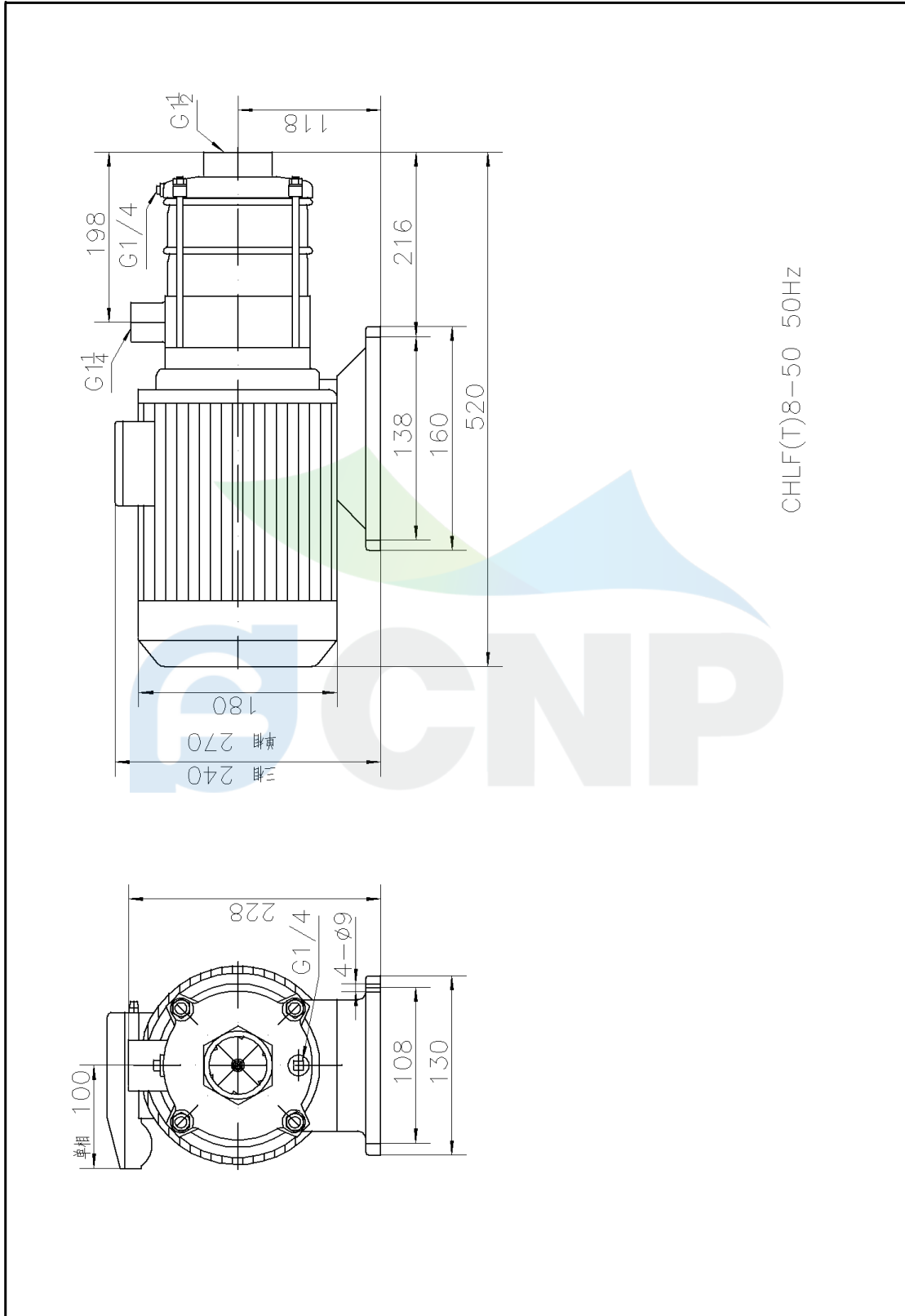

CHLF(T)8-50 50HZ