	<b>Product Information</b> <b>CHLF2-40</b>	Manufacturer	CNP
		Address	Yuhang District, Hangzhou, Zhejiang,
Project Name		Contact	86-571-88637351
		Date	2022/03/06
Item NO		Client Name	DPA
		Client Addr.	
		Contacts	Alireza
		Contact	

Part NO.	1100048197
----------	------------

Product Picture	Note
	<p>Product introduction</p> <p>Horizontal multistage non-self-priming centrifugal pump with close coupling motor; Impellers and diffusers are made of stainless steel plate with stamping and welding technology; Axial inlet and radial outlet.</p> <p>Performance and advantages</p> <p>Compact structure Low noise Suitable for slightly corrosive liquid Small installation space</p> <p>Application</p>

<b>technology</b>	
Pump rotator speed	2900
Pump version	2
<b>Material</b>	
Impeller	304
Rubber code	P
Material Code	S
<b>Installation</b>	
Connection Code	L
Installation type	horizontal
Maximum Pressure/Temperatur	10 bar
Maximum Pressure/Temperatur	10 bar
<b>Medium</b>	
Medium Temperature normal	-15+70
Medium Temperature high t	-15+105
Maximum Environment Temper	40
<b>Structure dimension</b>	
Inlet Bore	G1
Outlet Diameter	G1
Rotation Direction	Clockwise
<b>Motor</b>	
Number of Motor Phase	Three Phase
Protection Class	IP55
Insulation Class	F
Motor Power	0.55
Power Frequency	50
Rated Voltage (V)	380V
Energy Efficiency Level	IE2
<b>Seal</b>	
Mechanical Seal	CHL-16/BSF4
<b>Others</b>	
Weight (kg)	11



# Performance Curve CHLF2-40

Manufacturer	CNP
Address	Yuhang District, Hangzhou, Zhejiang,
Contact	86-571-88637351
Date	2022/03/06
Client Name	DPA
Client Addr.	
Contacts	Alireza
Contact	

Project Name

Item NO

The hydraulic performance curve have been tested with Clean Water at 20°C, density 1000kg/m<sup>3</sup>, and at 1bar atmospheric pressure. ISO99062012 Grade 3B

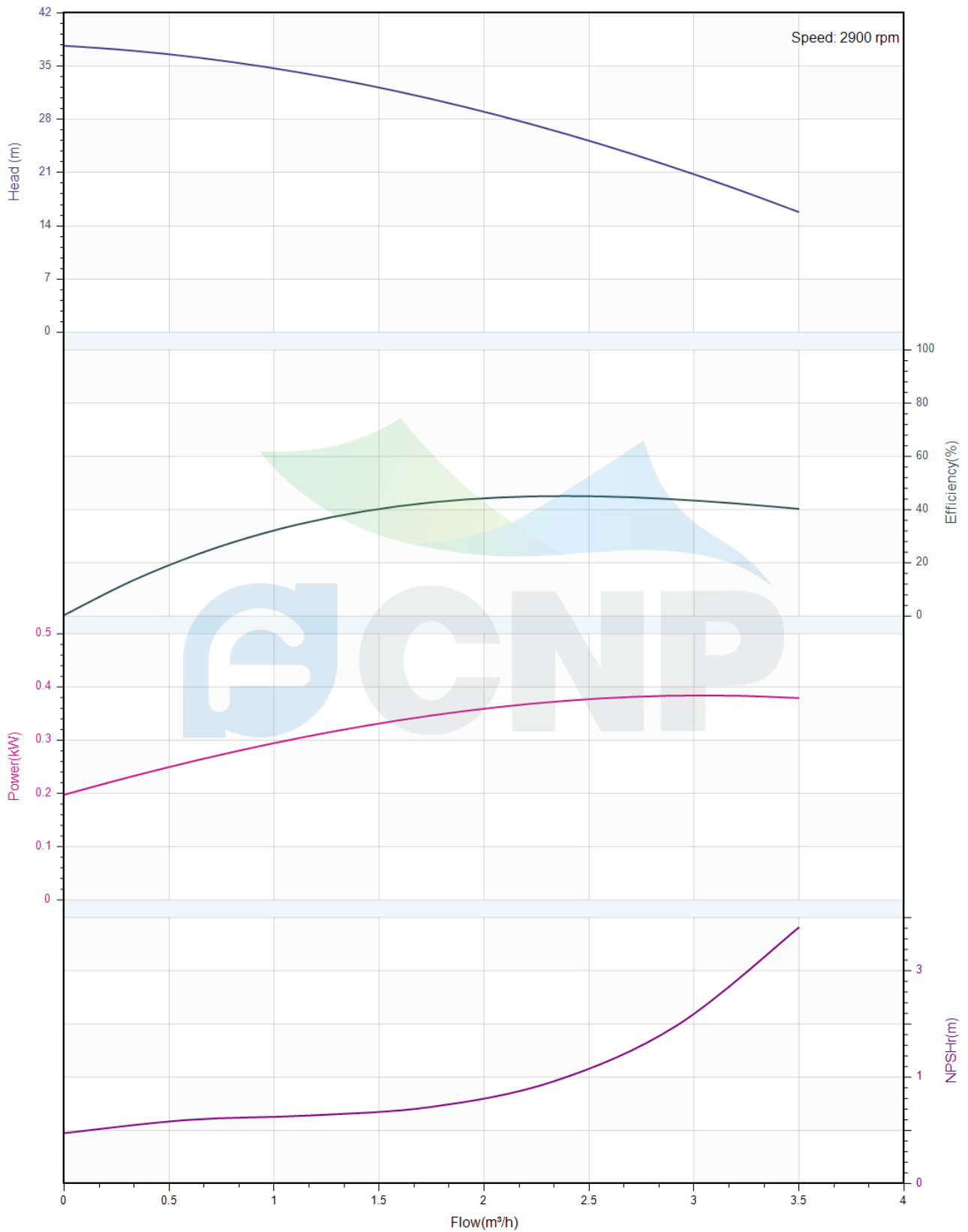



## Pump Technical Parameters CHLF2-40

Manufacturer	CNP
Address	Yuhang District, Hangzhou, Zhejiang,
Contact	86-571-88637351
Date	2022/03/06
Client Name	DPA
Client Addr.	
Contacts	Alireza
Contact	

### Rated parameters

Pump model	CHLF2-40
Part NO.	1100048197
Rated flow (m <sup>3</sup> /h)	2
Rated head (m)	29
Rated efficiency (%)	41
Power (kW)	0.39
NPSHr (m)	2
Speed (rpm)	2900
Max impeller diameter (mm)	90

### Medium

Pumped medium	Clean Water
Working temperature (°C)	20
Medium density (kg/m <sup>3</sup> )	1000
Viscosity (mm <sup>2</sup> /s)	1

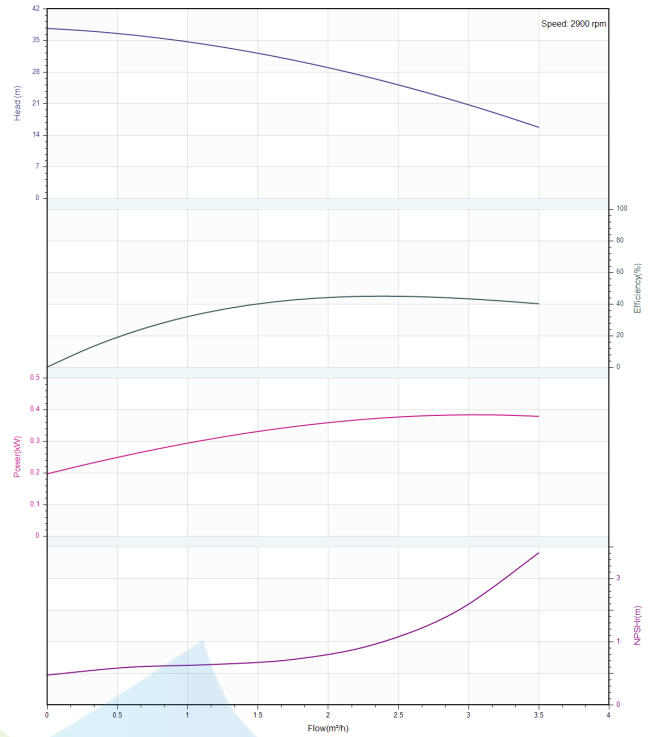



**Structure picture**  
**CHLF2-40**

Manufacturer	CNP
Address	Yuhang District, Hangzhou, Zhejiang,
Contact	86-571-88637351
Date	2022/03/06
Client Name	DPA
Client Addr.	
Contacts	Alireza
Contact	

Project Name

Item NO

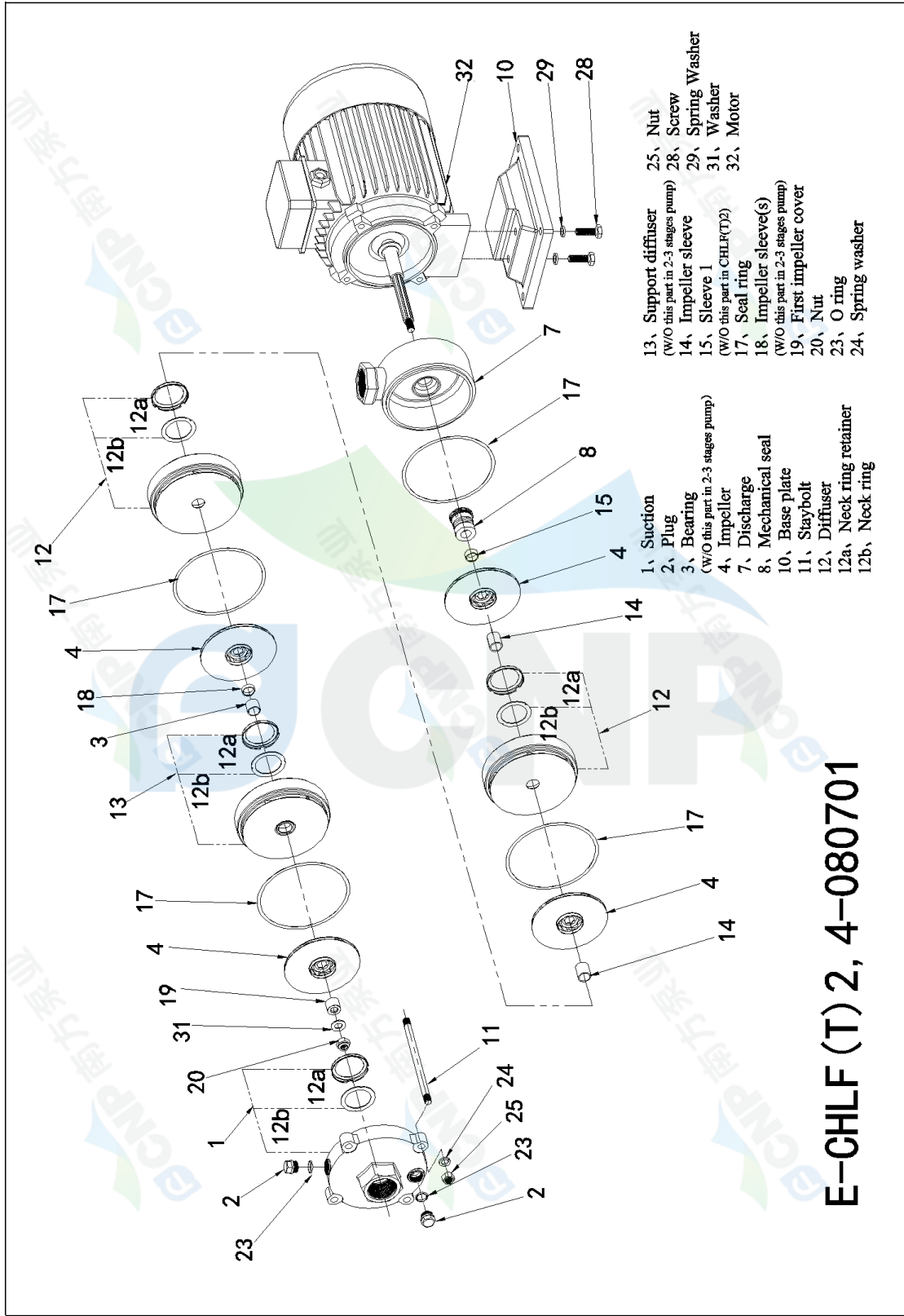

- 13, Support diffuser (w/o this part in 2-3 stages pump)
  - 14, Impeller sleeve (w/o this part in 2-3 stages pump)
  - 15, Sleeve 1 (w/o this part in CHLR(T)2)
  - 17, Seal ring
  - 18, Impeller sleeve(s) (w/o this part in 2-3 stages pump)
  - 19, First impeller cover (w/o this part in 2-3 stages pump)
  - 20, Nut
  - 23, O ring
  - 24, Spring washer
  - 25, Nut
  - 28, Screw
  - 29, Spring Washer
  - 31, Washer
  - 32, Motor
- 1, Suction
  - 2, Plug
  - 3, Bearing (w/o this part in 2-3 stages pump)
  - 4, Impeller
  - 7, Discharge
  - 8, Mechanical seal
  - 10, Base plate
  - 11, Staybolt
  - 12, Diffuser
  - 12a, Neck ring retainer
  - 12b, Neck ring

**E-CHLF (T) 2, 4-080701**



### Dimension Drawing CHLF2-40

Manufacturer	CNP
Address	Yuhang District, Hangzhou, Zhejiang,
Contact	86-571-88637351
Date	2022/03/06
Client Name	DPA
Client Addr.	
Contacts	Alireza
Contact	

Project Name

Item NO

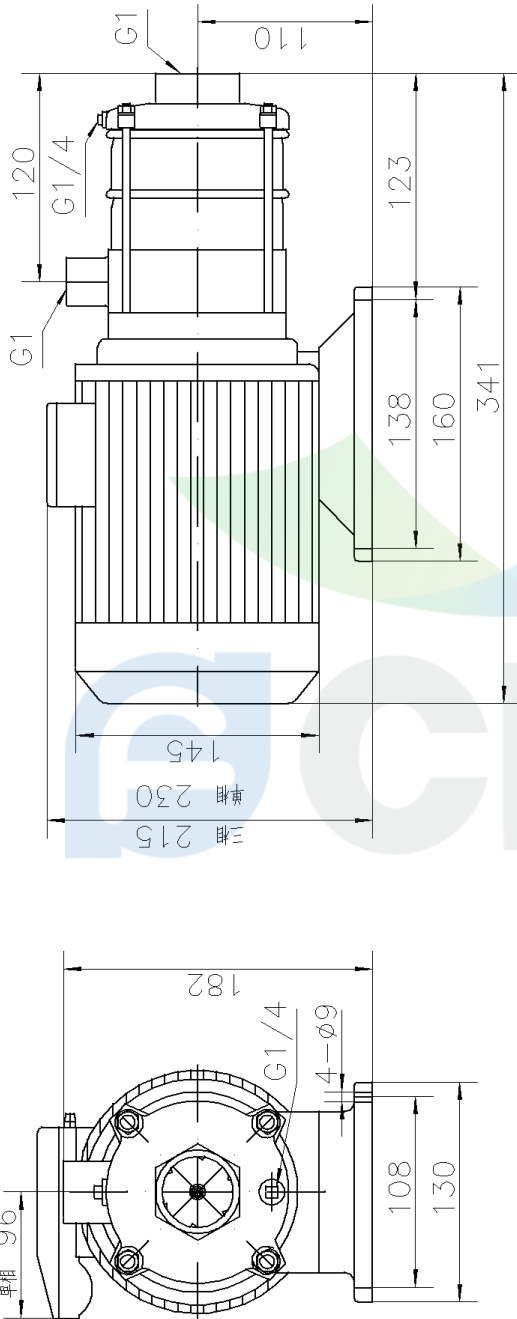

CHLF(T)2-40 50Hz