



|  |   |              |                                      |
|--|---|--------------|--------------------------------------|
|  | <b>Product Information</b><br><b>CHLF2-30</b> | Manufacturer | CNP                                  |
|  |   | Address      | Yuhang District, Hangzhou, Zhejiang, |
| <b>Project Name</b>  |   | Contact      | 86-571-88637351                      |
|  |   | Date         | 2022/03/06                           |
|  |   | Client Name  | DPA                                  |
| <b>Item NO</b>   |   | Client Addr. |                                      |
|  |   | Contacts     | Alireza                              |
|  |   | Contact      |                                      |

|          |            |
|----------|------------|
| Part NO. | 1100048115 |
|----------|------------|

|   |  |
|---|--|
| Product Picture   | Note   |
|  | <p>Product introduction</p> <p>Horizontal multistage non-self-priming centrifugal pump with close coupling motor; Impellers and diffusers are made of stainless steel plate with stamping and welding technology; Axial inlet and radial outlet.</p> <p>Performance and advantages</p> <p>Compact structure<br/>Low noise<br/>Suitable for slightly corrosive liquid<br/>Small installation space</p> <p>Application</p> |

|                             |             |
|-----------------------------|-------------|
| <b>technology</b>           |             |
| Pump rotator speed          | 2900        |
| Pump version                | 2           |
| <b>Material</b>             |             |
| Impeller                    | 304         |
| Rubber code                 | P           |
| Material Code               | S           |
| <b>Installation</b>         |             |
| Connection Code             | L           |
| Installation type           | horizontal  |
| Maximum Pressure/Temperatur | 10 bar      |
| Maximum Pressure/Temperatur | 10 bar      |
| <b>Medium</b>               |             |
| Medium Temperature normal   | -15+70      |
| Medium Temperature high t   | -15+105     |
| Maximum Environment Temper  | 40          |
| <b>Structure dimension</b>  |             |
| Inlet Bore                  | G1          |
| Outlet Diameter             | G1          |
| Rotation Direction          | Clockwise   |
| <b>Motor</b>                |             |
| Number of Motor Phase       | Three Phase |
| Protection Class            | IP55        |
| Insulation Class            | F           |
| Motor Power                 | 0.37        |
| Power Frequency             | 50          |
| Rated Voltage (V)           | 380V        |
| Energy Efficiency Level     | IE2         |
| <b>Seal</b>                 |             |
| Mechanical Seal             | CHL-16/BSF4 |
| <b>Others</b>               |             |
| Weight (kg)                 | 10          |



### Performance Curve CHLF2-30

|              |                                      |
|--------------|--------------------------------------|
| Manufacturer | CNP                                  |
| Address      | Yuhang District, Hangzhou, Zhejiang, |
| Contact      | 86-571-88637351                      |
| Date         | 2022/03/06                           |
| Client Name  | DPA                                  |
| Client Addr. |                                      |
| Contacts     | Alireza                              |
| Contact      |                                      |

|              |  |
|--------------|--|
| Project Name |  |
| Item NO      |  |

The hydraulic performance curve have been tested with Clean Water at 20°C, density 1000kg/m<sup>3</sup>, and at 1bar atmospheric pressure. ISO99062012 Grade 3B

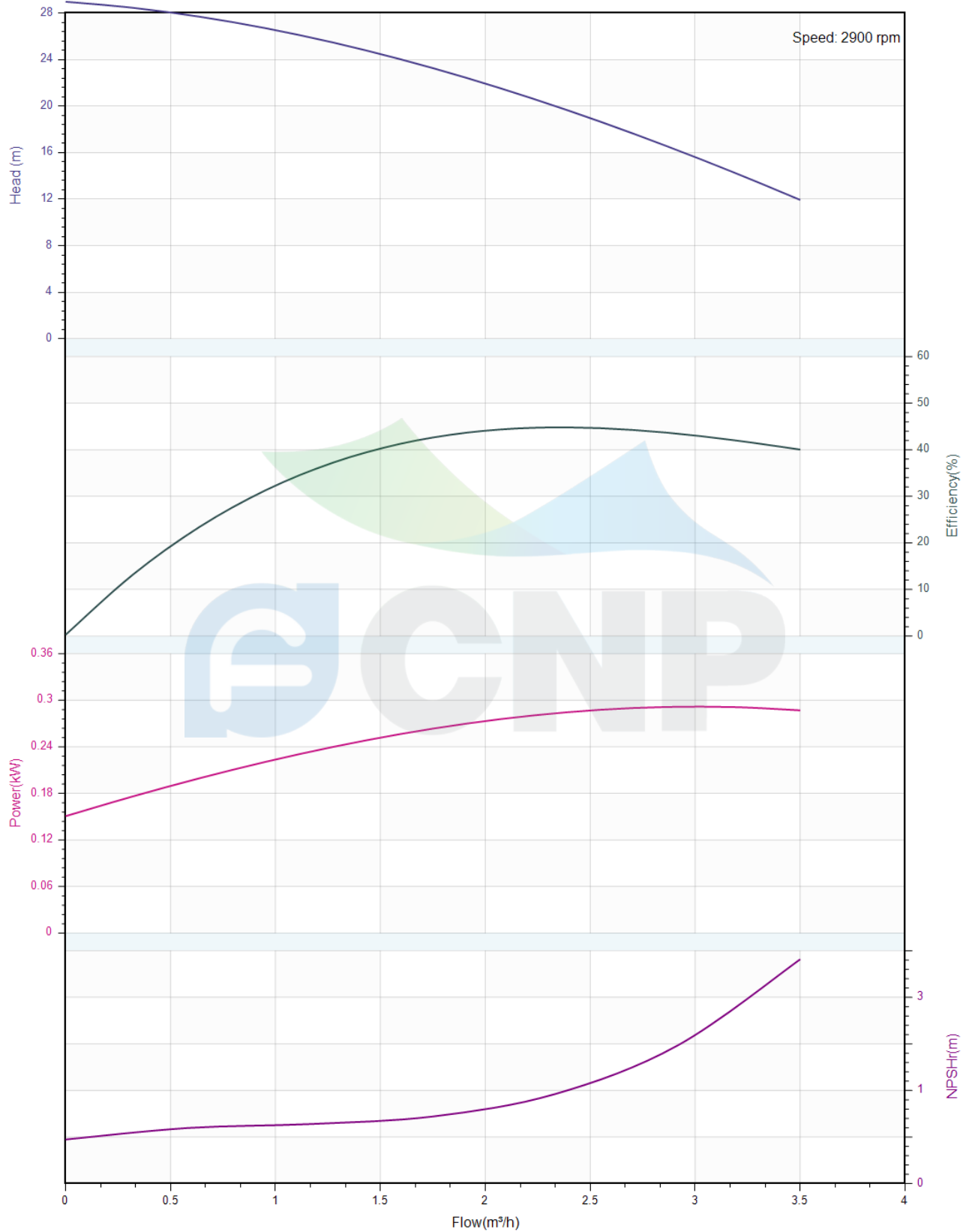



## Pump Technical Parameters CHLF2-30

|              |                                      |
|--------------|--------------------------------------|
| Manufacturer | CNP                                  |
| Address      | Yuhang District, Hangzhou, Zhejiang, |
| Contact      | 86-571-88637351                      |
| Date         | 2022/03/06                           |
| Client Name  | DPA                                  |
| Client Addr. |                                      |
| Contacts     | Alireza                              |
| Contact      |                                      |

### Rated parameters

|                                |            |
|--------------------------------|------------|
| Pump model                     | CHLF2-30   |
| Part NO.                       | 1100048115 |
| Rated flow (m <sup>3</sup> /h) | 2          |
| Rated head (m)                 | 22         |
| Rated efficiency (%)           | 41         |
| Power (kW)                     | 0.29       |
| NPSHr (m)                      | 2          |
| Speed (rpm)                    | 2900       |
| Max impeller diameter (mm)     | 90         |

### Medium

|                                     |             |
|-------------------------------------|-------------|
| Pumped medium                       | Clean Water |
| Working temperature (°C)            | 20          |
| Medium density (kg/m <sup>3</sup> ) | 1000        |
| Viscosity (mm <sup>2</sup> /s)      | 1           |

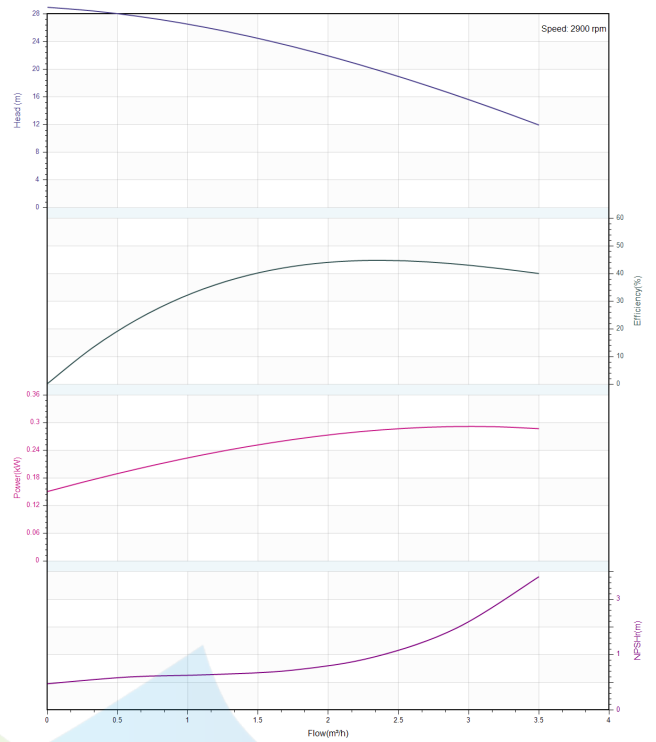



**Structure picture**  
**CHLF2-30**

|              |                                      |
|--------------|--------------------------------------|
| Manufacturer | CNP                                  |
| Address      | Yuhang District, Hangzhou, Zhejiang, |
| Contact      | 86-571-88637351                      |
| Date         | 2022/03/06                           |
| Client Name  | DPA                                  |
| Client Addr. |                                      |
| Contacts     | Alireza                              |
| Contact      |                                      |

Project Name

Item NO

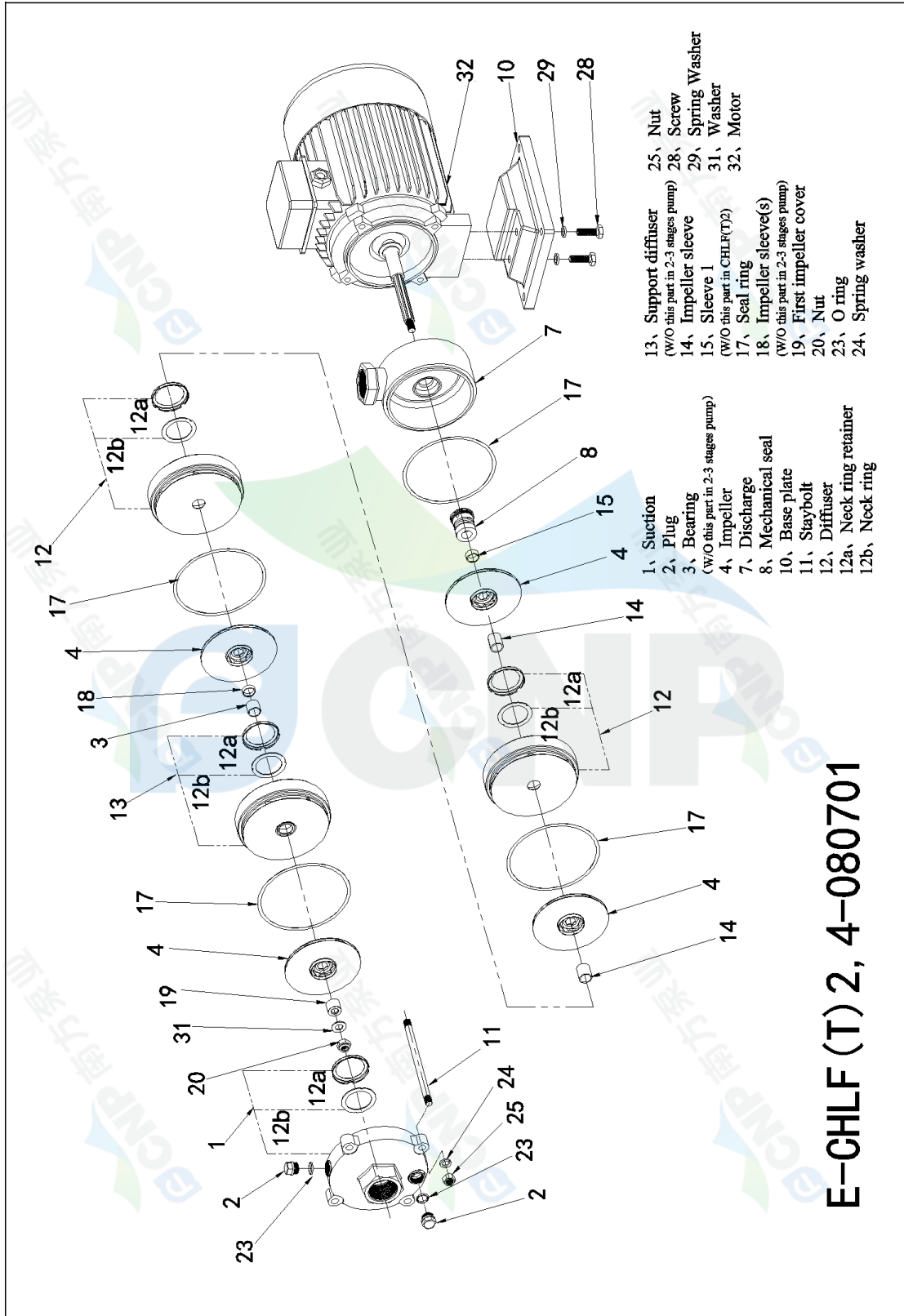

- 13, Support diffuser (w/o this part in 2-3 stages pump)
  - 14, Impeller sleeve (w/o this part in 2-3 stages pump)
  - 15, Sleeve 1 (w/o this part in CHLR(T)2)
  - 17, Seal ring
  - 18, Impeller sleeve(s) (w/o this part in 2-3 stages pump)
  - 19, First impeller cover
  - 20, Nut
  - 23, O ring
  - 24, Spring washer
  - 25, Nut
  - 28, Screw
  - 29, Spring Washer
  - 31, Washer
  - 32, Motor
- 1, Suction
  - 2, Plug
  - 3, Bearing (w/o this part in 2-3 stages pump)
  - 4, Impeller
  - 7, Discharge
  - 8, Mechanical seal
  - 10, Base plate
  - 11, Staybolt
  - 12, Diffuser
  - 12a, Neck ring retainer
  - 12b, Neck ring

**E-CHLF (T) 2, 4-080701**



### Dimension Drawing CHLF2-30

|              |                                      |
|--------------|--------------------------------------|
| Manufacturer | CNP                                  |
| Address      | Yuhang District, Hangzhou, Zhejiang, |
| Contact      | 86-571-88637351                      |
| Date         | 2022/03/06                           |
| Client Name  | DPA                                  |
| Client Addr. |                                      |
| Contacts     | Alireza                              |
| Contact      |                                      |

Project Name

Item NO

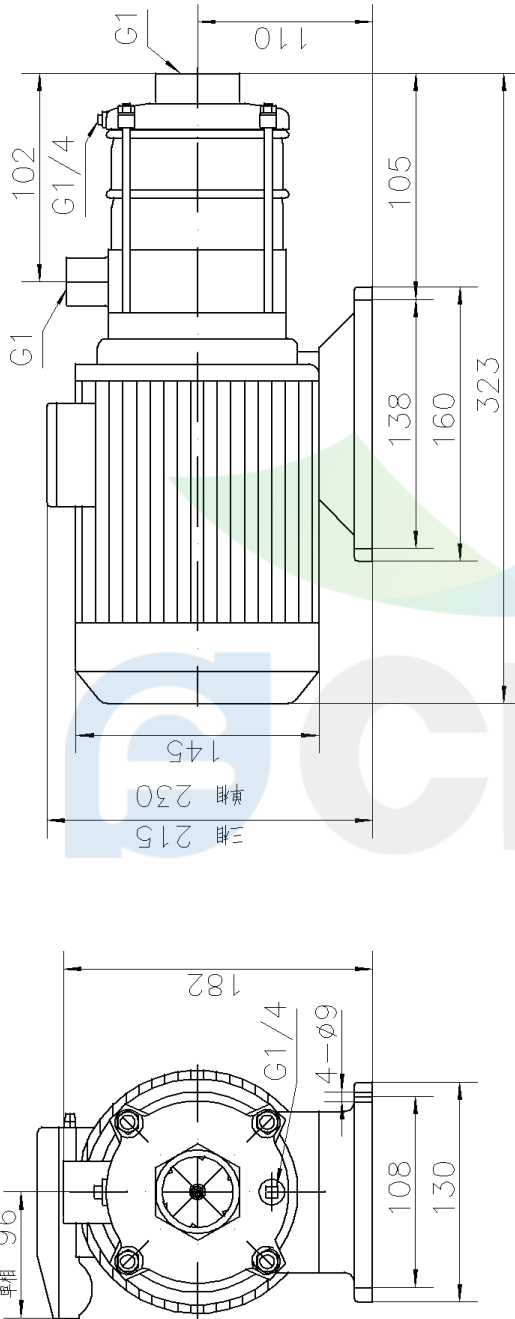

CHLF(T)2-30 50Hz