	Product Information CHLF2-20	Manufacturer	CNP
		Address	Yuhang District, Hangzhou, Zhejiang,
Project Name		Contact	86-571-88637351
		Date	2022/03/06
Item NO		Client Name	DPA
		Client Addr.	
		Contacts	Alireza
		Contact	

Part NO.	1100048046
----------	------------

Product Picture	Note
	<p>Product introduction</p> <p>Horizontal multistage non-self-priming centrifugal pump with close coupling motor; Impellers and diffusers are made of stainless steel plate with stamping and welding technology; Axial inlet and radial outlet.</p> <p>Performance and advantages</p> <p>Compact structure Low noise Suitable for slightly corrosive liquid Small installation space</p> <p>Application</p>

technology	
Pump rotator speed	2900
Pump version	2
Material	
Impeller	304
Rubber code	P
Material Code	S
Installation	
Connection Code	L
Installation type	horizontal
Maximum Pressure/Temperatur	10 bar
Maximum Pressure/Temperatur	10 bar
Medium	
Medium Temperature normal	-15+70
Medium Temperature high t	-15+105
Maximum Environment Temper	40
Structure dimension	
Inlet Bore	G1
Outlet Diameter	G1
Rotation Direction	Clockwise
Motor	
Number of Motor Phase	Three Phase
Protection Class	IP55
Insulation Class	F
Motor Power	0.37
Power Frequency	50
Rated Voltage (V)	380V
Energy Efficiency Level	IE2
Seal	
Mechanical Seal	CHL-16/BSF4
Others	
Weight (kg)	9



Performance Curve CHLF2-20

Manufacturer	CNP
Address	Yuhang District, Hangzhou, Zhejiang,
Contact	86-571-88637351
Date	2022/03/06
Client Name	DPA
Client Addr.	
Contacts	Alireza
Contact	

Project Name

Item NO

The hydraulic performance curve have been tested with Clean Water at 20°C, density 1000kg/m³, and at 1bar atmospheric pressure. ISO99062012 Grade 3B

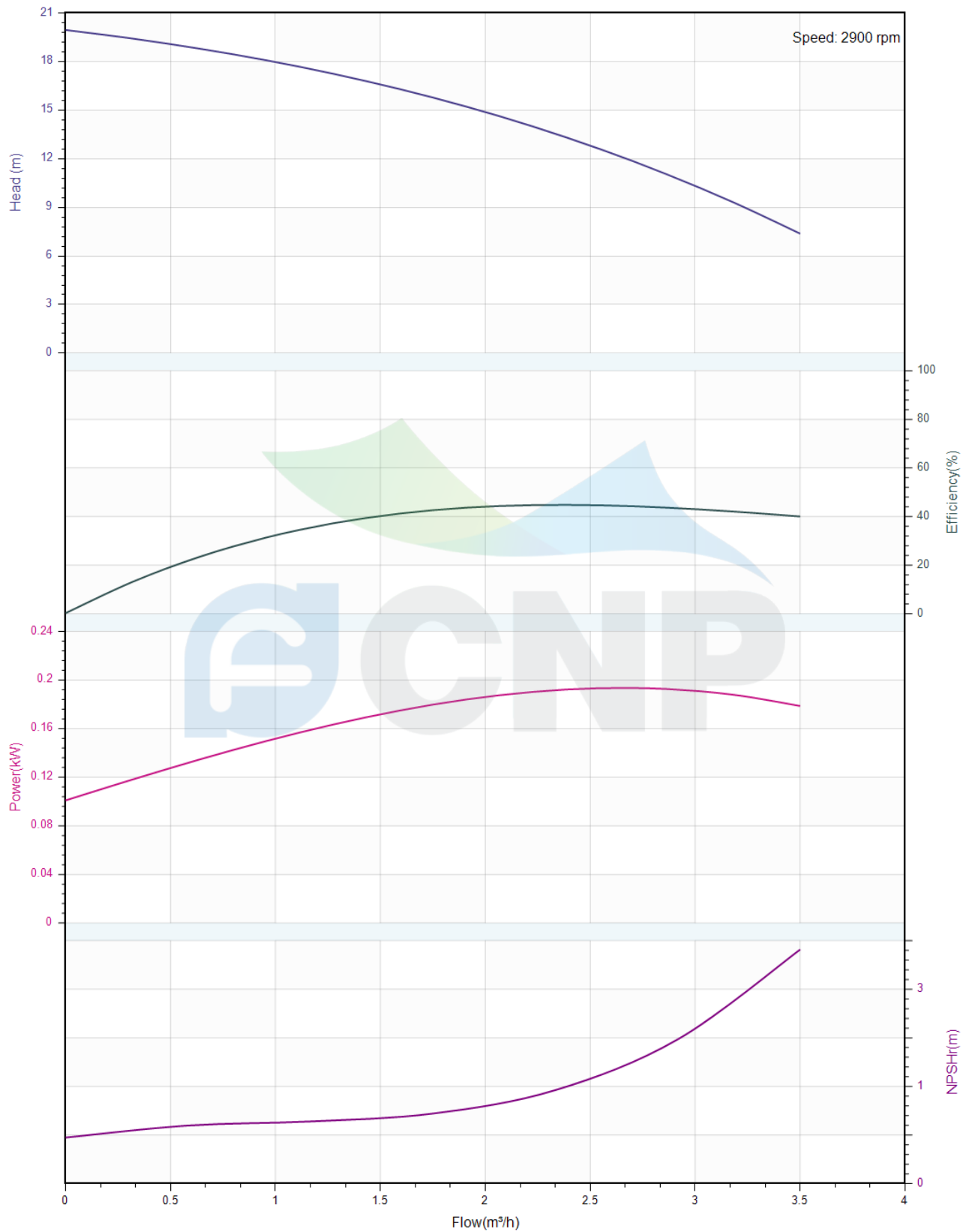



Pump Technical Parameters CHLF2-20

Manufacturer	CNP
Address	Yuhang District, Hangzhou, Zhejiang,
Contact	86-571-88637351
Date	2022/03/06
Client Name	DPA
Client Addr.	
Contacts	Alireza
Contact	

Rated parameters

Pump model	CHLF2-20
Part NO.	1100048046
Rated flow (m ³ /h)	2
Rated head (m)	15
Rated efficiency (%)	41
Power (kW)	0.2
NPSHr (m)	2
Speed (rpm)	2900
Max impeller diameter (mm)	90

Medium

Pumped medium	Clean Water
Working temperature (°C)	20
Medium density (kg/m ³)	1000
Viscosity (mm ² /s)	1

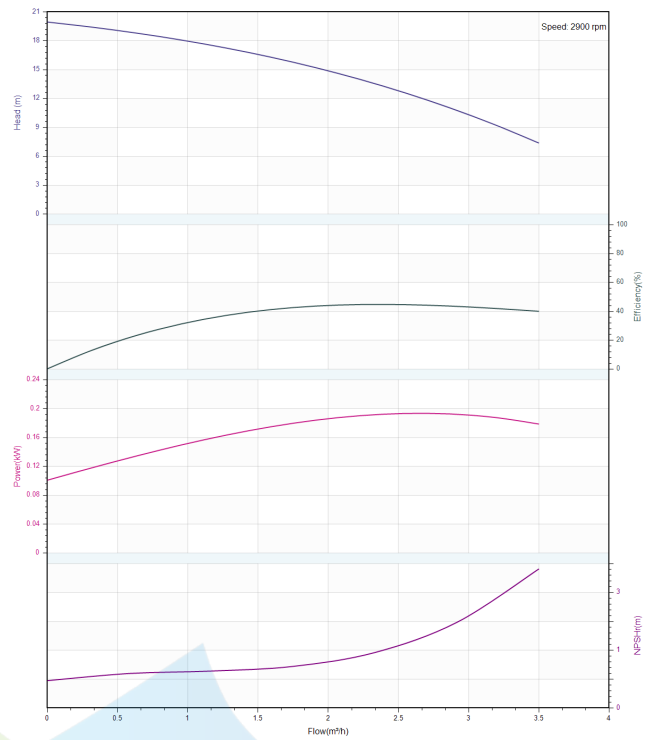



Structure picture
CHLF2-20

Manufacturer	CNP
Address	Yuhang District, Hangzhou, Zhejiang,
Contact	86-571-88637351
Date	2022/03/06
Client Name	DPA
Client Addr.	
Contacts	Alireza
Contact	

Project Name

Item NO

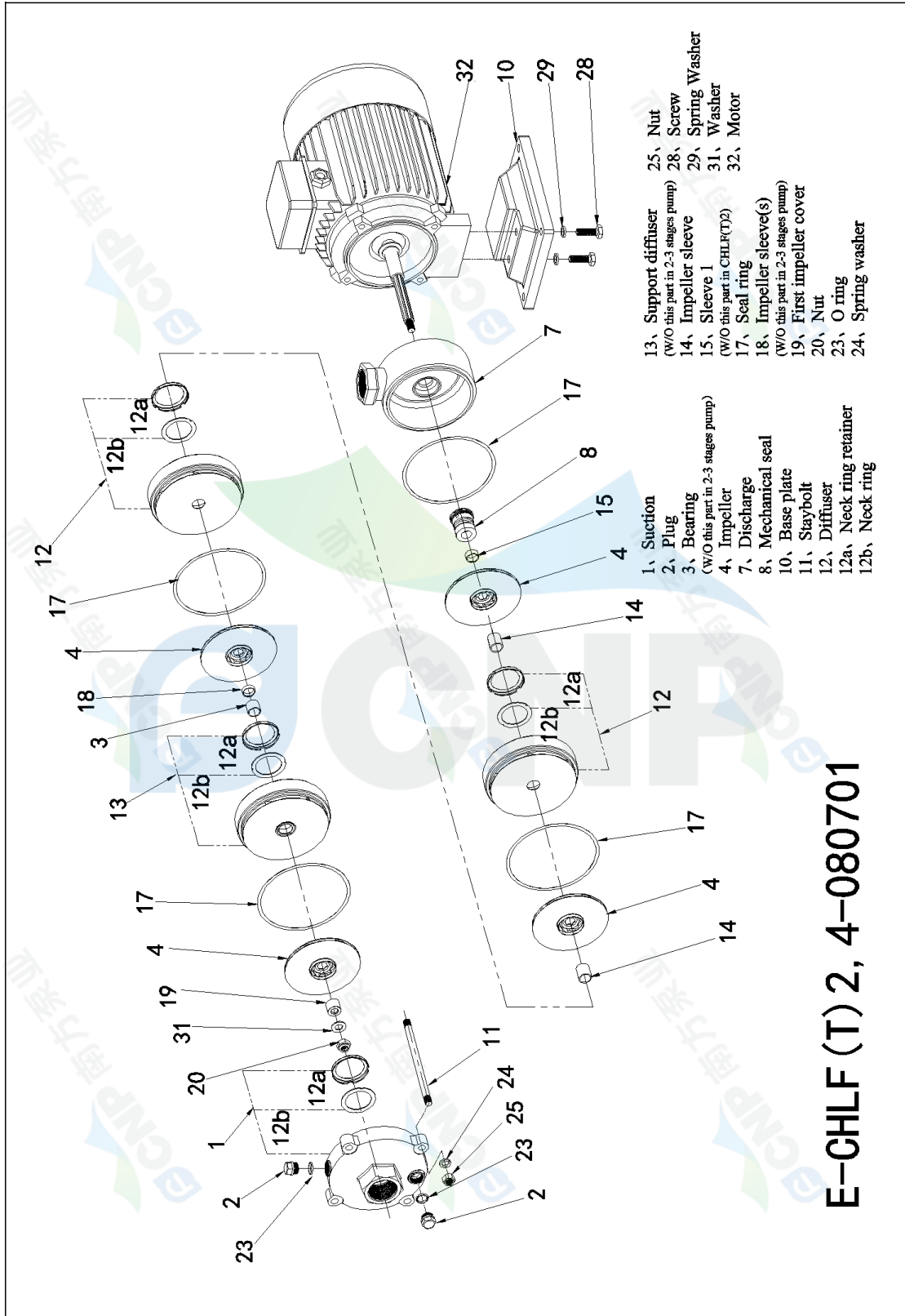

- | | |
|--|-------------------|
| 13, Support diffuser
(w/o this part in 2-3 stages pump) | 25, Nut |
| 14, Impeller sleeve | 28, Screw |
| 15, Sleeve 1
(w/o this part in CHLR(T)2) | 29, Spring Washer |
| 17, Seal ring | 31, Washer |
| 18, Impeller sleeve(s)
(w/o this part in 2-3 stages pump) | 32, Motor |
| 19, First impeller cover | |
| 20, Nut | |
| 23, O ring | |
| 24, Spring washer | |
| 1, Suction | |
| 2, Plug | |
| 3, Bearing
(w/o this part in 2-3 stages pump) | |
| 4, Impeller | |
| 7, Discharge | |
| 8, Mechanical seal | |
| 10, Base plate | |
| 11, Staybolt | |
| 12, Diffuser | |
| 12a, Neck ring retainer | |
| 12b, Neck ring | |

E-CHLF (T) 2, 4-080701



Dimension Drawing CHLF2-20

Manufacturer	CNP
Address	Yuhang District, Hangzhou, Zhejiang,
Contact	86-571-88637351
Date	2022/03/06
Client Name	DPA
Client Addr.	
Contacts	Alireza
Contact	

Project Name

Item NO

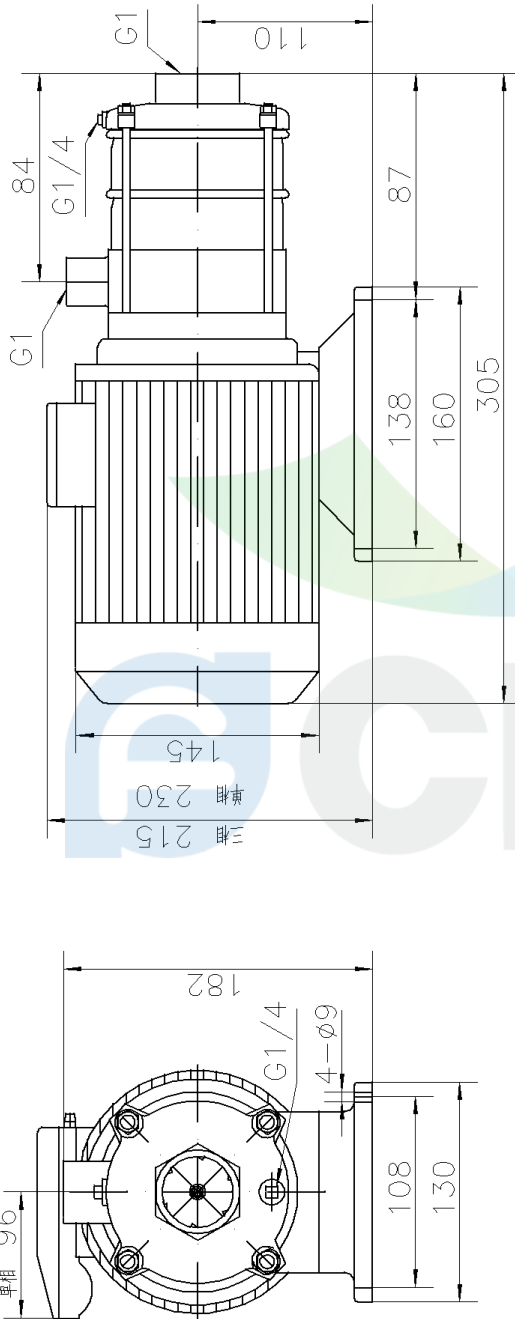

CHLF(T)2-20 50Hz