	Product Information CHLF12-20	Manufacturer	CNP
		Address	Yuhang District, Hangzhou, Zhejiang,
Project Name		Contact	86-571-88637351
		Date	2022/03/06
Item NO		Client Name	DPA
		Client Addr.	
		Contacts	Alireza
		Contact	

Part NO.	1100048968
----------	------------

Product Picture	Note
	<p>Product introduction</p> <p>Horizontal multistage non-self-priming centrifugal pump with close coupling motor; Impellers and diffusers are made of stainless steel plate with stamping and welding technology; Axial inlet and radial outlet.</p> <p>Performance and advantages</p> <p>Compact structure Low noise Suitable for slightly corrosive liquid Small installation space</p> <p>Application</p>

technology	
Pump rotator speed	2900
Pump version	2
Material	
Impeller	304
Rubber code	P
Material Code	S
Installation	
Connection Code	L
Installation type	horizontal
Maximum Pressure/Temperatur	10 bar
Maximum Pressure/Temperatur	10 bar
Medium	
Medium Temperature normal	-15+70
Medium Temperature high t	-15+105
Maximum Environment Temper	40
Structure dimension	
Inlet Bore	G1 1/2
Outlet Diameter	G1 1/2
Rotation Direction	Clockwise
Motor	
Number of Motor Phase	Three Phase
Protection Class	IP55
Insulation Class	F
Motor Power	1.2
Power Frequency	50
Rated Voltage (V)	380V
Energy Efficiency Level	IE2
Seal	
Mechanical Seal	CHL-20/BSF4
Others	
Weight (kg)	19



Performance Curve CHLF12-20

Manufacturer	CNP
Address	Yuhang District, Hangzhou, Zhejiang,
Contact	86-571-88637351
Date	2022/03/06
Client Name	DPA
Client Addr.	
Contacts	Alireza
Contact	

Project Name	
Item NO	

The hydraulic performance curve have been tested with Clean Water at 20°C, density 1000kg/m³, and at 1bar atmospheric pressure. ISO99062012 Grade 3B

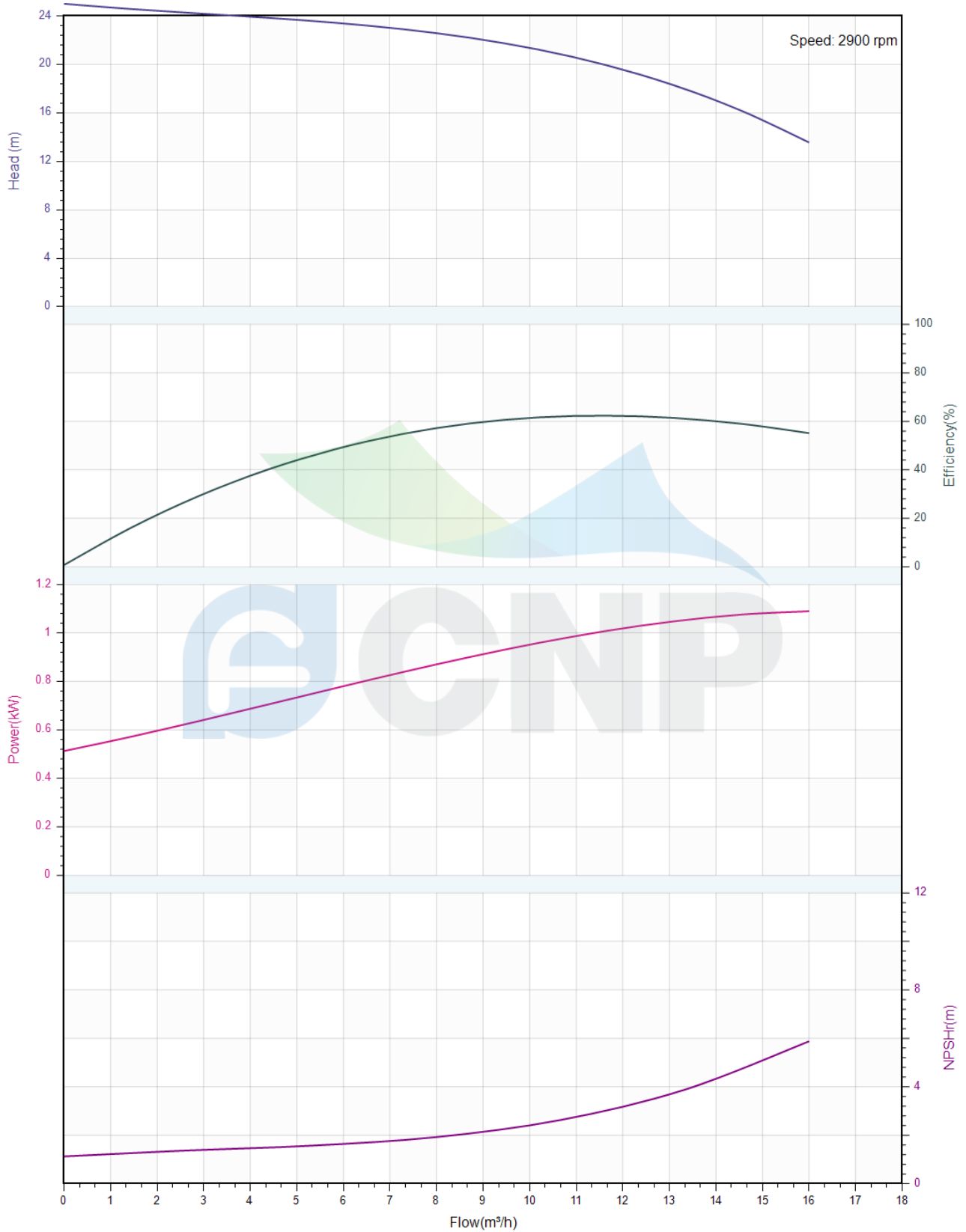



Pump Technical Parameters CHLF12-20

Manufacturer	CNP
Address	Yuhang District, Hangzhou, Zhejiang,
Contact	86-571-88637351
Date	2022/03/06
Client Name	DPA
Client Addr.	
Contacts	Alireza
Contact	

Rated parameters

Pump model	CHLF12-20
Part NO.	1100048968
Rated flow (m ³ /h)	12
Rated head (m)	19.5
Rated efficiency (%)	60
Power (kW)	1.06
NPSHr (m)	2.5
Speed (rpm)	2900
Max impeller diameter (mm)	105

Medium

Pumped medium	Clean Water
Working temperature (°C)	20
Medium density (kg/m ³)	1000
Viscosity (mm ² /s)	1

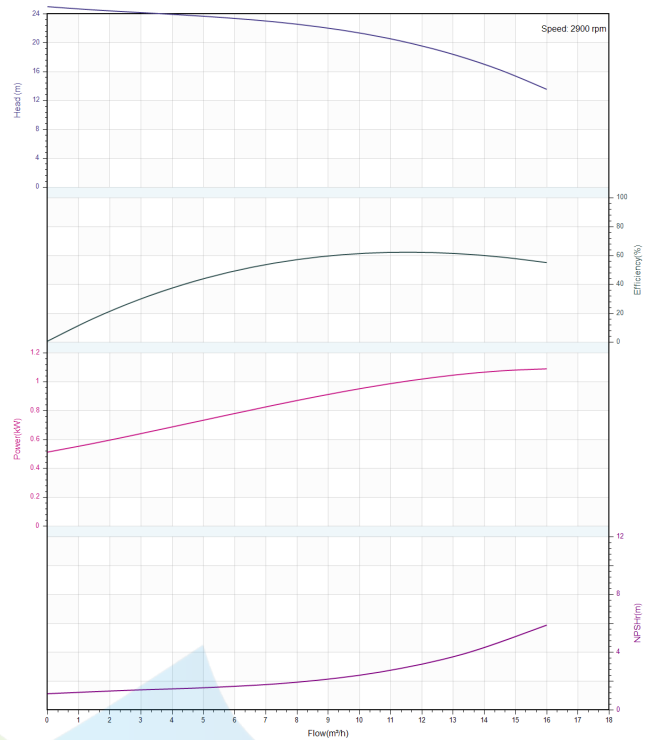



Structure picture
CHLF12-20

Manufacturer	CNP
Address	Yuhang District, Hangzhou, Zhejiang,
Contact	86-571-88637351
Date	2022/03/06
Client Name	DPA
Client Addr.	
Contacts	Alireza
Contact	

Project Name

Item NO

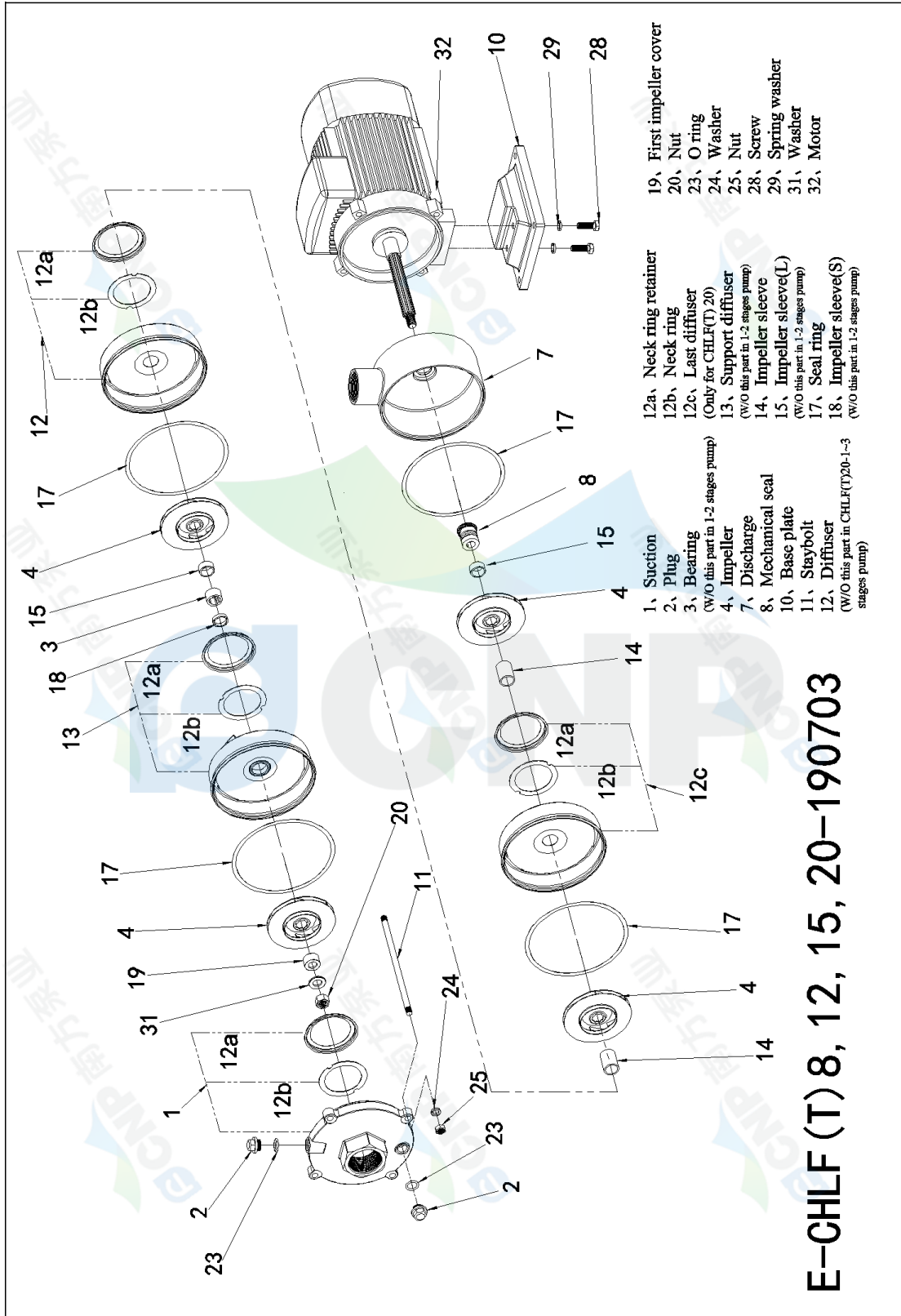

- 19, First impeller cover
 - 20, Nut
 - 23, O ring
 - 24, Washer
 - 25, Nut
 - 28, Screw
 - 29, Spring washer
 - 31, Washer
 - 32, Motor
- 12a, Neck ring retainer
 - 12b, Neck ring
 - 12c, Last diffuser (Only for CHLF(T) 20)
 - 13, Support diffuser (w/o this part in 1-2 stages pump)
 - 14, Impeller sleeve (w/o this part in 1-2 stages pump)
 - 15, Impeller sleeve(L) (w/o this part in 1-2 stages pump)
 - 17, Seal ring
 - 18, Impeller sleeve(S) (w/o this part in 1-2 stages pump)
- 1, Suction
 - 2, Plug
 - 3, Bearing (w/o this part in 1-2 stages pump)
 - 4, Impeller
 - 7, Discharge
 - 8, Mechanical seal
 - 10, Base plate
 - 11, Staybolt
 - 12, Diffuser (w/o this part in CHLF(T)20-1-3 stages pump)

E-CHLF (T) 8, 12, 15, 20-190703



Dimension Drawing CHLF12-20

Manufacturer	CNP
Address	Yuhang District, Hangzhou, Zhejiang,
Contact	86-571-88637351
Date	2022/03/06
Client Name	DPA
Client Addr.	
Contacts	Alireza
Contact	

Project Name

Item NO

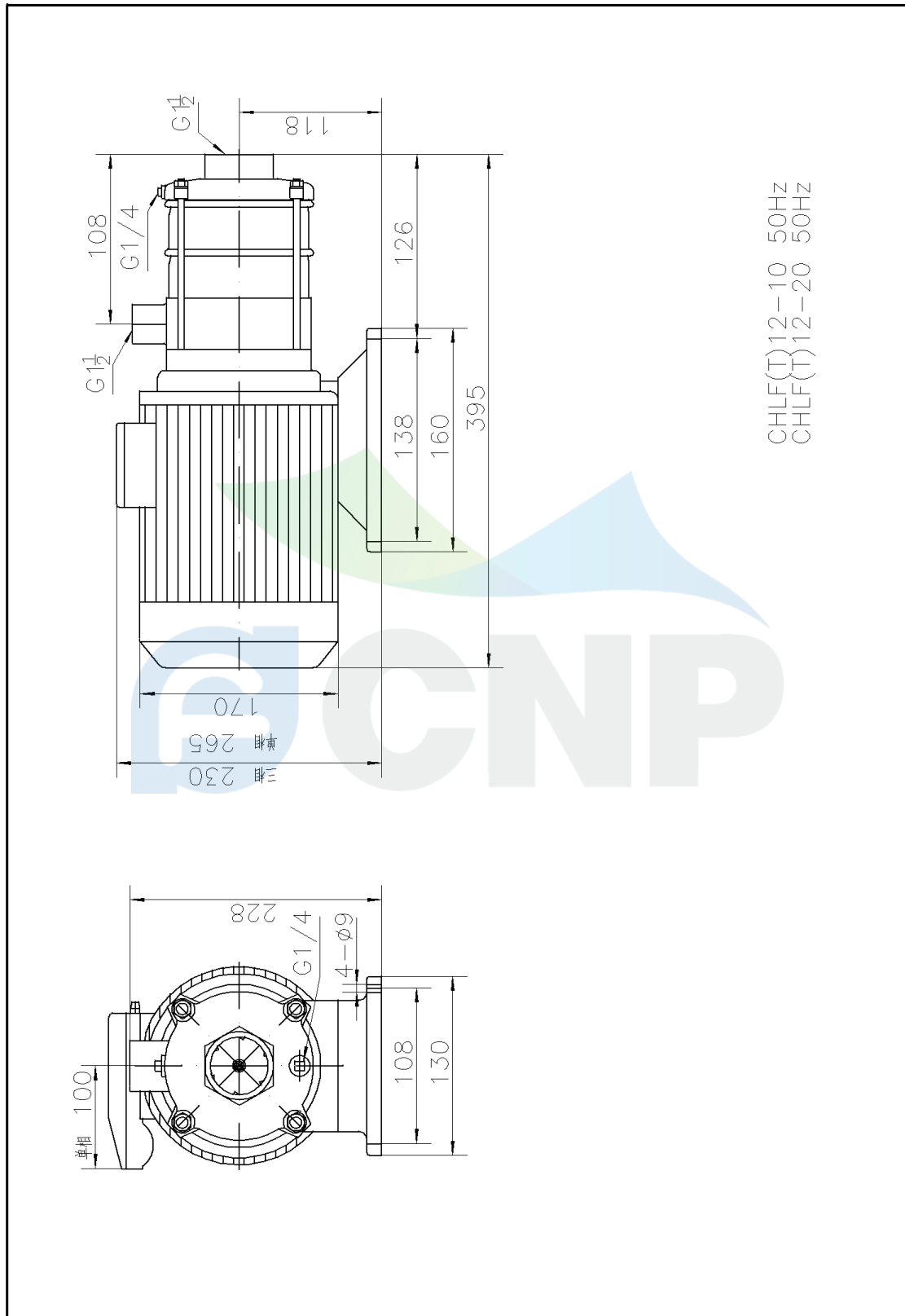

CHLF(T)12-10 50HZ
CHLF(T)12-20 50HZ