

**Receiver**
**From**

 Society  
 Reference  
 Address  
 Phone  
 Fax  
 E-mail

**Item n° :**

105100004

**Model :**

ALM 200 M

**Pump data**

 Pressure rating : 10 bar (1000 kPa)  
 Min. fluid temperature : 5 °F  
 Max. fluid temperature : 248 °F  
 Max. Ambient temperature : 104 °F

**Requested data**

 Flow : 0/00 US g.p.m.  
 Head : 0/00 m  
 Fluid (%) : Water, pure  
 Fluid Temperature : 68 °F  
 Density : 62/322 lb/ft<sup>3</sup>  
 Kinematic viscosity : 1/0818E-5 ft<sup>2</sup>/s  
 Vapor pressure : 2/34 kPa

**Hydraulic data (duty point)**

 Flow :  
 Head :  
 NPSH :  
 Shaft power P2 :  
 Efficiency :

**Materials**

 Pump body : Bronze G Cu Sn5 Pc5 UNI 7013/8-72  
 Support : Bronze G Cu Sn5 Pc5 UNI 7013/8-72  
 Impeller : Technopolymer  
 Mechanical seal : Carbon/Ceramic  
 OR ring : EPDM Rubber  
 Shaft with rotor : AISI 303 X10 CrNiS 1809 UNI 6900/71

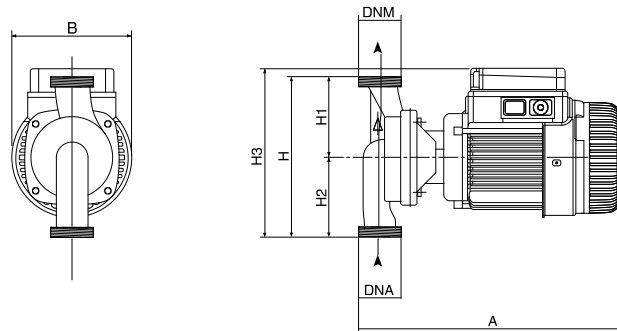
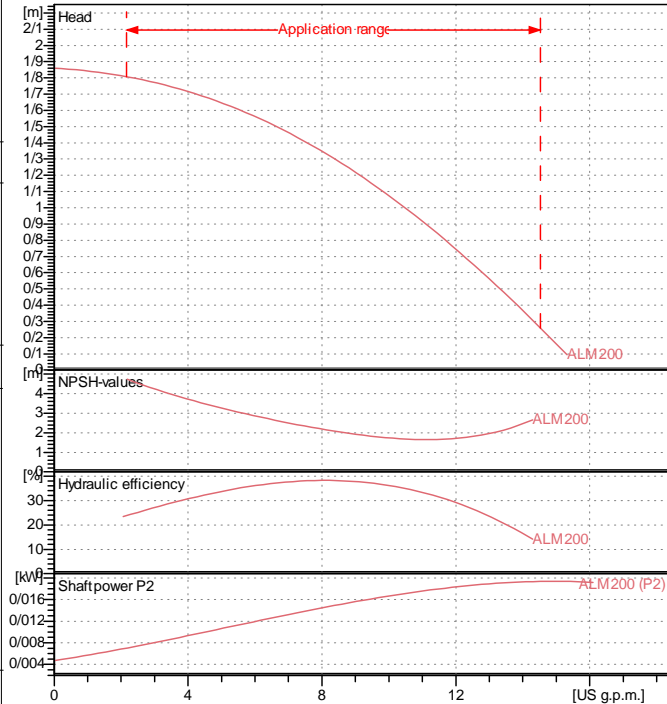
**Curve tolerance according to ISO 9906**

**Weight :** 7/5 kg

**Motor data**

 Motor brand : DAB  
 Nominal power P2 : 0/059 kW  
 Rated speed : 1480 rpm  
 Rated voltage : 1~ 220-240 V 50 Hz  
 Nominal current : 0/7 A  
 Degree of protection : IP 55

**Dimensions in mm**

A	300	H3	190		
B	136				
DNA	1" 1/2 G				
DNM	1" 1/2 G				
H	180				
H1	90				
H2	90				

**Pump connection**

 Suction side : 1" 1/2 G-M10 bar (1000 kPa)  
 Discharge side : 1" 1/2 G-M10 bar (1000 kPa)