

Receiver

From

Society
 Reference
 Address
 Phone
 Fax
 E-mail

Item n° :

60167630

Model :

K 70/400 T IE3

Pump data
MEI ≥

Pressure rating : 12 bar (1200 kPa)

Min. fluid temperature : 5 °F

Max. fluid temperature : 230 °F

Max. Ambient temperature : 104 °F

Requested data

Flow : 0/00 US g.p.m.

Head : 0/00 m

Fluid : Water, pure

Fluid Temperature : 68 °F

 Density : 62/322 lb/ft³

 Kinematic viscosity : 1/0818E-5 ft²/s

Vapor pressure : 2/34 kPa

Hydraulic data (duty point)

Flow :

Head :

NPSH :

Shaft power P2 :

Efficiency :

Materials

Pump body : Cast iron 200 UNI ISO 185

Support : Cast iron 200 UNI ISO 185

Impeller : Technopoly mer B

Mechanical seal : Carbon/Ceramic

OR ring : Guarnital

Shaft with rotor : AISI 304 X5 Cr Ni 1810 UNI 6900/71

Intermediate cover : Cast iron 200 UNI ISO 185

Motor data

Motor brand : DAB

Nominal power P2 : 9/2 kW

Rated speed : 2900 rpm

Rated voltage : 3~ 400 V 50 Hz

Nominal current : 18 A

Degree of protection : IP 55

Pump connection

Suction side : 2" G / 12 bar (1200 kPa)

Discharge side : 1" 1/4 G/ 12 bar (1200 kPa)

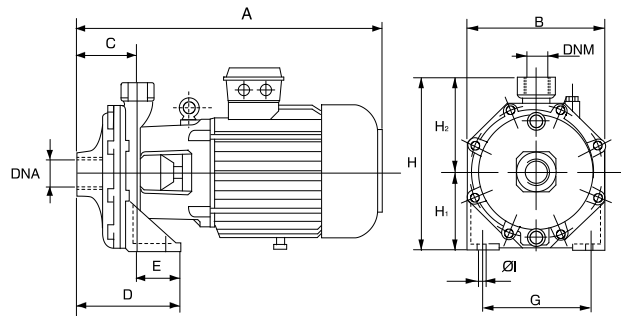
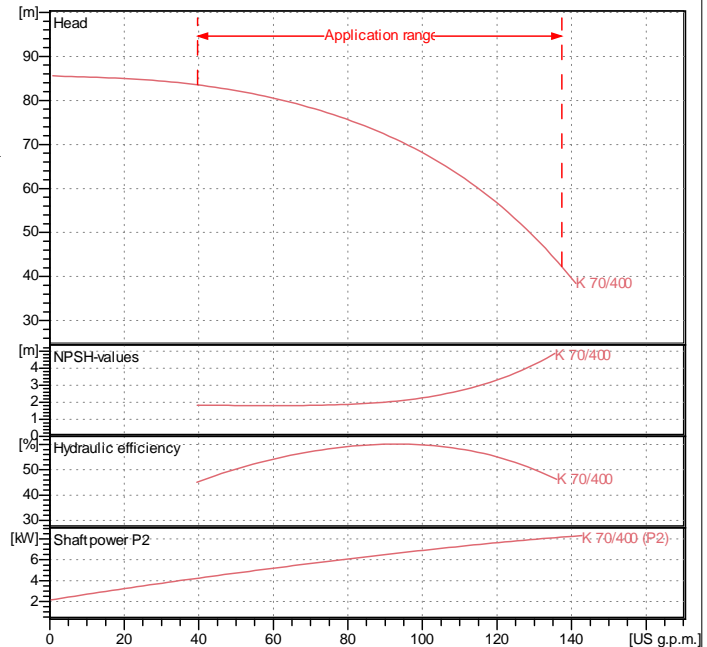
Curve tolerance according to ISO 9906

Weight : 74 kg

Dimensions in mm

| | | | |
|-----|----------|----|----|
| A | 635 | I? | 14 |
| B | 270 | | |
| C | 122 | | |
| D | 182 | | |
| DNA | 2" G | | |
| DNM | 1" 1/4 G | | |
| E | 60 | | |
| F | 20 | | |
| G | 210 | | |
| H | 340 | | |
| H1 | 160 | | |
| H2 | 180 | | |