

**Receiver**
**From**

Society  
 Reference  
 Address  
 Phone  
 Fax  
 E-mail

**Item n° :**

60161483.

**Model :**

K 30/12 HA

**Pump data**

Pressure rating : 4 bar (400 KPa)  
 Min. fluid temperature : 32 °F  
 Max. fluid temperature : 212 °F  
 Max. Ambient temperature : 131 °F

**Requested data**

Flow : 0/00 US g.p.m.  
 Head : 0/00 m  
 Fluid : Water, pure  
 Fluid Temperature : 68 °F  
 Density : 62/322 lb/ft<sup>3</sup>  
 Kinematic viscosity : 1/0818E-5 ft<sup>2</sup>/s  
 Vapor pressure : 2/34 kPa

**Hydraulic data (duty point)**

Flow :  
 Head :  
 NPSH :  
 Shaft power P2 :  
 Efficiency :

**Materials**

Pump body : Cast iron with cataphoresis  
 Support : Cast iron with cataphoresis  
 Impeller : Technopolymer B  
 Mechanical seal : Carbon/Ceramic  
 OR ring : NBR Rubber  
 Shaft with rotor : AISI 416 X12 CrS 13 UNI 6900/71

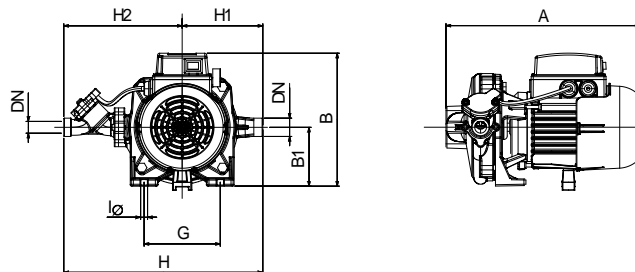
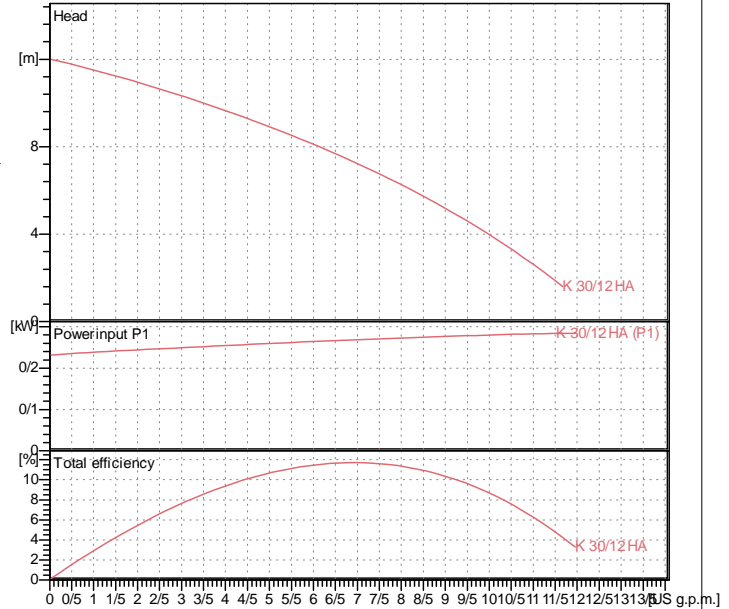
**Curve tolerance according to ISO 9906**

**Weight :** 7/9 kg

**Motor data**

Motor brand : DAB  
 Power input P1 : 0/28 kW  
 Rated speed : 2800 rpm  
 Rated voltage : 1~ 220-230 V 50 Hz  
 Nominal current : 1/28 A  
 Degree of protection : IP 44

**Dimensions in mm**

A	282
B	192
B1	85
DN	3/4" G
G	110
H	287/5
H1	116/5
H2	171
I?	9/5

**Pump connection**

Suction side : 3/4" G / 4 bar (400 KPa)  
 Discharge side : 3/4" G / 4 bar (400 KPa)