

Receiver

From

Society
 Reference
 Address
 Phone
 Fax
 E-mail

Item n° :

60161484.

Model :

K 20/9 HA

Pump data

Pressure rating : 4 bar (400 KPa)
 Min. fluid temperature : 32 °F
 Max. fluid temperature : 212 °F
 Max. Ambient temperature : 131 °F

Requested data

Flow : 0/00 US g.p.m.
 Head : 0/00 m
 Fluid : Water, pure
 Fluid Temperature : 68 °F
 Density : 62/322 lb/ft³
 Kinematic viscosity : 1/0818E-5 ft²/s
 Vapor pressure : 2/34 kPa

Hydraulic data (duty point)

Flow :
 Head :
 NPSH :
 Shaft power P2 :
 Efficiency :

Materials

Pump body : Cast iron with cataphoresis
 Support : Cast iron with cataphoresis
 Impeller : Technopolymer B
 Mechanical seal : Carbon/Ceramic
 OR ring : NBR Rubber
 Shaft with rotor : AISI 416 X12 CrS 13 UNI 6900/71

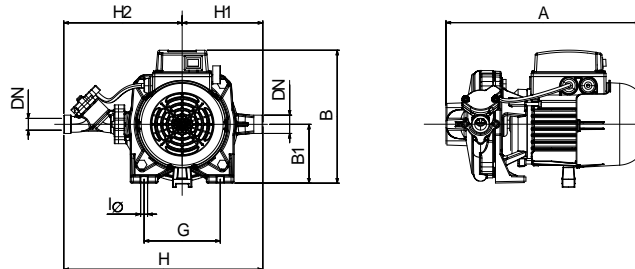
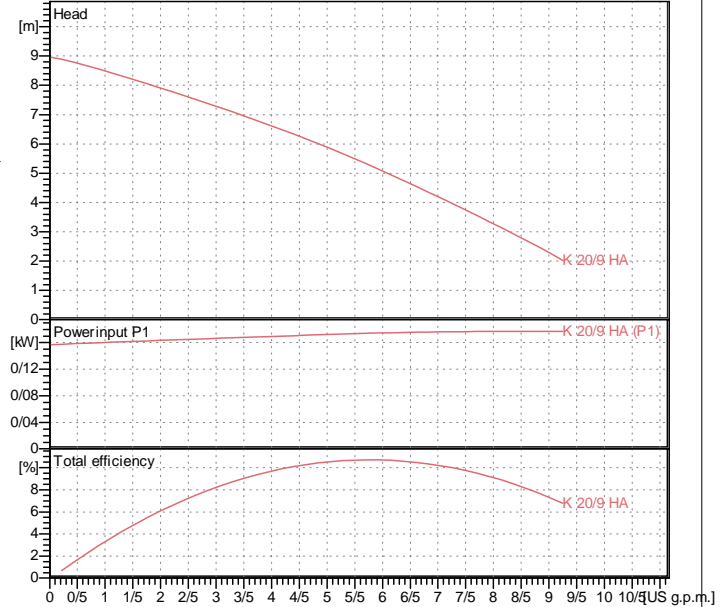
Curve tolerance according to ISO 9906

Weight : 5/4 kg

Motor data

Motor brand : DAB
 Power input P1 : 0/18 kW
 Rated speed : 2800 rpm
 Rated voltage : 1~ 220-230 V 50 Hz
 Nominal current : 0/82 A
 Degree of protection : IP 44

Dimensions in mm

A : 253
 B : 172
 B1 : 65
 DN : 3/4" G
 G : 70
 H : 231
 H1 : 83
 H2 : 148
 I? : 8

Pump connection

Suction side : 3/4" G / 4 bar (400 KPa)
 Discharge side : 3/4" G / 4 bar (400 KPa)