

Receiver
From

 Society
 Reference
 Address
 Phone
 Fax
 E-mail

Item n° :

1D5411BAX

Model :

NKM-G 80-250/240/A/BAQE/7,5/4 IE3

Pump data

Impeller size (mm) : 240

MEI ≥ 0,40

Pressure rating : PN 16

Min. fluid temperature : 14 °F

Max. fluid temperature : 284 °F

Max. Ambient temperature : 104 °F

Requested data

Flow : 0/00 US g.p.m.

Head : 0/00 m

Fluid (%) : Water, pure

Fluid Temperature : 68 °F

 Density : 62/322 lb/ft³

 Kinematic viscosity : 1/0818E-5 ft²/s

Vapor pressure : 2/34 kPa

Real duty point

Flow :

Head :

NPSH :

Shaft power P2 :

Efficiency :

Materials

Pump body : Cast iron 250 UNI ISO 185

Support : Cast iron 250 UNI ISO 185

Impeller : Cast iron 250 UNI ISO 185

Mechanical seal : SEE "SHAFT SEAL" SECTION

OR ring : Ethylene propylene (EPDM)

Pump shaft : AISI 304 X5 Cr Ni 1810 UNI 6900/71

Motor : AISI 304 X5 Cr Ni 1810 UNI 6900/71

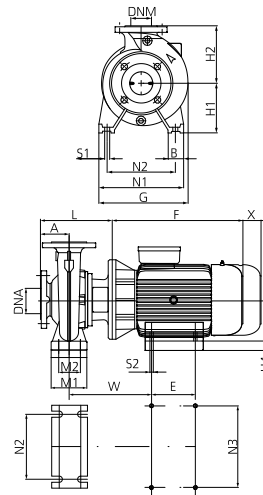
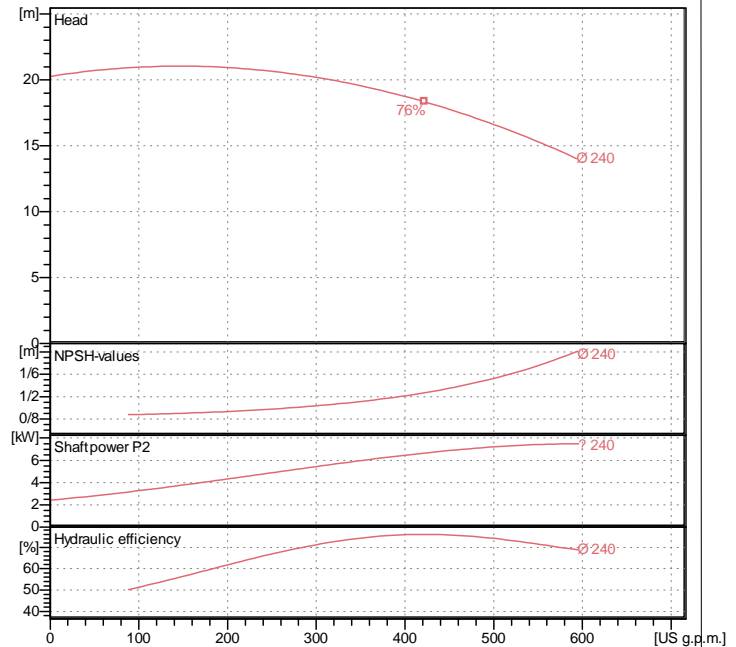
Curve tolerance according to ISO 9906

Shaft seal

Type : Rubber

Stationary part : Carbon

Rotating part : Silicon carbide

Elastomer : EPDM

Motor data

Nominal power P2 : 7/5 kW

Rated speed : 1463 rpm

Rated voltage : 3~ 400 V

50 Hz

Nominal current : 14/6 A

Degree of protection : IP 55

Weight : 153 kg

Dimensions in mm

A	125	H1	200	N2	315
B	80	H2	280	N3	-
DNA	100	H4	-	S1	M14
DNM	80	L	368	S2	-
E	-	M1	160	W	-
F	437	M2	120	X	140
G	410	N1	400		

Pump connection

Suction side : DN 100 / PN 16

Discharge side : DN 80 / PN 16