

**Receiver**
**From**

 Society  
 Reference  
 Address  
 Phone  
 Fax  
 E-mail

**Item n° :**

1D4511BBX

**Model :**

NKM-G 65-315/309/A/BAQE/11/4 IE3

**Pump data**

Impeller size (mm) : 309

MEI ≥ 0,40

Pressure rating : PN 16

Min. fluid temperature : 14 °F

Max. fluid temperature : 284 °F

Max. Ambient temperature : 104 °F

**Requested data**

Flow : 0/00 US g.p.m.

Head : 0/00 m

Fluid (%) : Water, pure

Fluid Temperature : 68 °F

Density : 62/322 lb/ft³

Kinematic viscosity : 1/0818E-5 ft²/s

Vapor pressure : 2/34 kPa

**Real duty point**

Flow :

Head :

NPSH :

Shaft power P2 :

Efficiency :

**Materials**

Pump body : Cast iron 250 UNI ISO 185

Support : Cast iron 250 UNI ISO 185

Impeller : Cast iron 250 UNI ISO 185

Mechanical seal : SEE "SHAFT SEAL" SECTION

OR ring : Ethylene propylene (EPDM)

Pump shaft : AISI 304 X5 Cr Ni 1810 UNI 6900/71

Motor : AISI 304 X5 Cr Ni 1810 UNI 6900/71

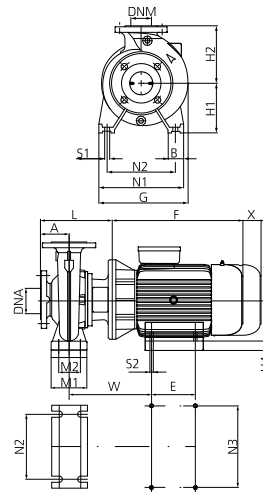
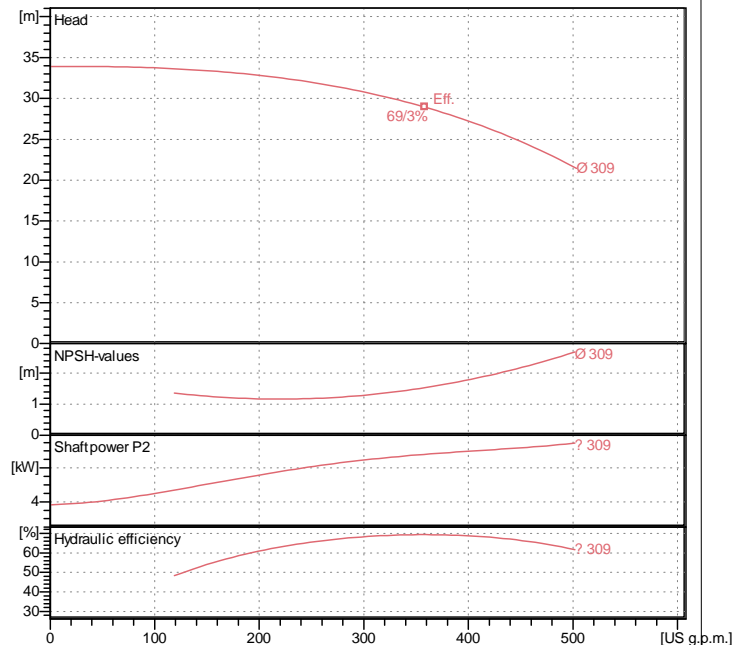
**Curve tolerance according to ISO 9906**

**Shaft seal**

 Type : Rubber  
 Stationary part : Carbon  
 Rotating part : Silicon carbide  
 Elastomer : EPDM

**Weight :** 231 kg

**Dimensions in mm**

A	125	H1	225	N2	315
B	80	H2	280	N3	254
DNA	80	H4	65	S1	M14
DNM	65	L	398	S2	M12
E	210	M1	160	W	402
F	505	M2	120	X	140
G	429	N1	400		

**Motor data**

 Nominal power P2 : 11 kW  
 Rated speed : 1472 rpm  
 Rated voltage : 3~ 400 V 50 Hz  
 Nominal current : 20/5 A  
 Degree of protection : IP 55

**Pump connection**

 Suction side : DN 80 / PN 16  
 Discharge side : DN 65 / PN 16