

Receiver
From

 Society
 Reference
 Address
 Phone
 Fax
 E-mail

Item n° :

1D4511BAX

Model :

NKM-G 65-315/279/A/BAQE/7,5/4 IE3

Pump data

Impeller size (mm) : 279

MEI ≥ 0,40

Pressure rating : PN 16

Min. fluid temperature : 14 °F

Max. fluid temperature : 284 °F

Max. Ambient temperature : 104 °F

Requested data

Flow : 0/00 US g.p.m.

Head : 0/00 m

Fluid (%) : Water, pure

Fluid Temperature : 68 °F

 Density : 62/322 lb/ft³

 Kinematic viscosity : 1/0818E-5 ft²/s

Vapor pressure : 2/34 kPa

Real duty point

Flow :

Head :

NPSH :

Shaft power P2 :

Efficiency :

Materials

Pump body : Cast iron 250 UNI ISO 185

Support : Cast iron 250 UNI ISO 185

Impeller : Cast iron 250 UNI ISO 185

Mechanical seal : SEE "SHAFT SEAL" SECTION

OR ring : Ethylene propylene (EPDM)

Pump shaft : AISI 304 X5 Cr Ni 1810 UNI 6900/71

Motor : AISI 304 X5 Cr Ni 1810 UNI 6900/71

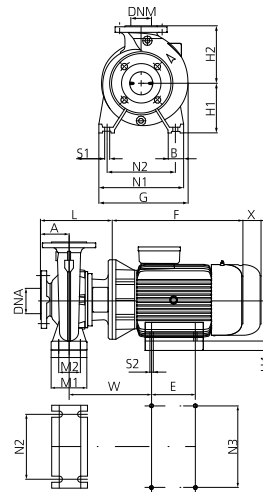
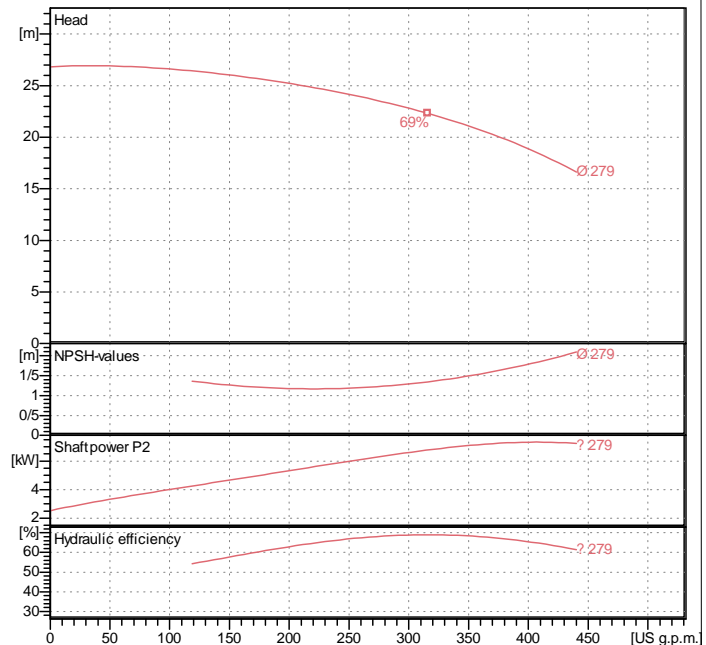
Curve tolerance according to ISO 9906

Shaft seal

 Type : Rubber
 Stationary part : Carbon
 Rotating part : Silicon carbide
 Elastomer : EPDM

Weight : 163 kg

Dimensions in mm

| Dimension | Value | Dimension | Value | Dimension | Value |
|-----------|-------|-----------|-------|-----------|-------|
| A | 125 | H1 | 225 | N2 | 315 |
| B | 80 | H2 | 280 | N3 | - |
| DNA | 80 | H4 | - | S1 | M14 |
| DNM | 65 | L | 368 | S2 | - |
| E | - | M1 | 160 | W | - |
| F | 437 | M2 | 120 | X | 140 |
| G | 429 | N1 | 400 | | |

Motor data

 Nominal power P2 : 7/5 kW
 Rated speed : 1463 rpm
 Rated voltage : 3~ 400 V 50 Hz
 Nominal current : 14/6 A
 Degree of protection : IP 55

Pump connection

 Suction side : DN 80 / PN 16
 Discharge side : DN 65 / PN 16