

Receiver
From

 Society
 Reference
 Address
 Phone
 Fax
 E-mail

Item n° :

1D8311BBX

Model :

NKM-G 150-200/218/A/BAQE/11/4 IE3

Pump data

Impeller size (mm) : 218

MEI ≥ -

Pressure rating : PN 16

Min. fluid temperature : 14 °F

Max. fluid temperature : 284 °F

Max. Ambient temperature : 104 °F

Requested data

Flow : 0/00 US g.p.m.

Head : 0/00 m

Fluid (%) : Water, pure

Fluid Temperature : 68 °F

Density : 62/322 lb/ft³

Kinematic viscosity : 1/0818E-5 ft²/s

Vapor pressure : 2/34 kPa

Real duty point

Flow :

Head :

NPSH :

Shaft power P2 :

Efficiency :

Materials

Pump body : Cast iron 250 UNI ISO 185

Support : Cast iron 250 UNI ISO 185

Impeller : Cast iron 250 UNI ISO 185

Mechanical seal : SEE "SHAFT SEAL" SECTION

OR ring : Ethylene propylene (EPDM)

Pump shaft : AISI 304 X5 Cr Ni 1810 UNI 6900/71

Motor : AISI 304 X5 Cr Ni 1810 UNI 6900/71

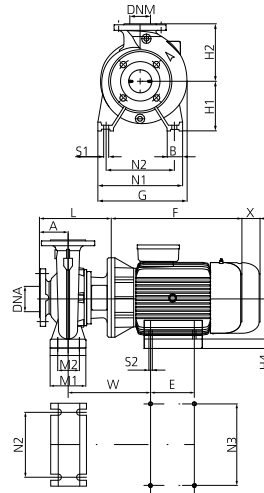
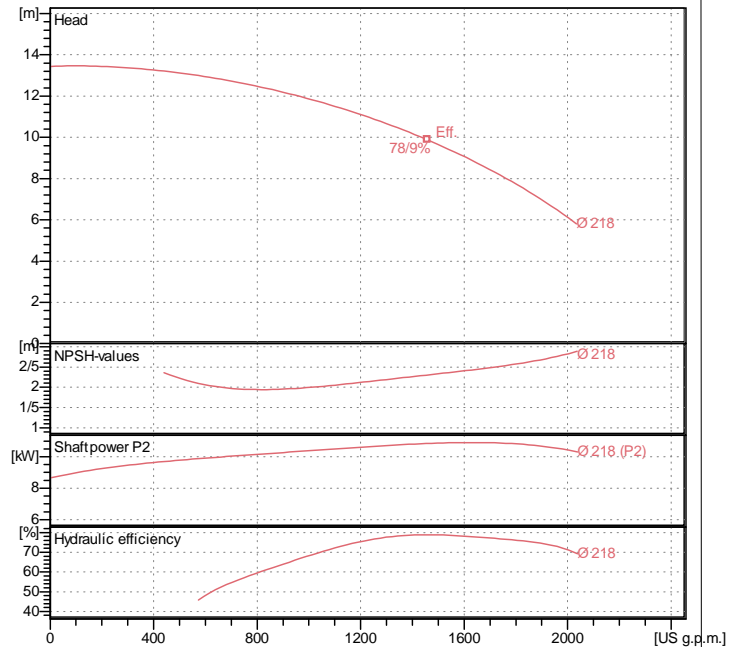
Curve tolerance according to ISO 9906

Weight : 280 kg

Dimensions in mm

Dimension	Value	Dimension	Value	Dimension	Value
A	160	H1	280	N2	450
B	100	H2	400	N3	254
DNA	200	H4	120	S1	M20
DNM	150	L	433	W	381
E	210	M1	200	X	140
F	505	M2	150		
G	593	N1	550		

Pump connection

Suction side : DN 200 / PN 16

Discharge side : DN 150 / PN 16

Motor data

Nominal power P2 : 11 kW

Rated speed : 1472 rpm

Rated voltage : 3~ 400 V 50 Hz

Nominal current : 20/5 A

Degree of protection : IP 55