

|                                                                                  |                                                        |              |                                      |
|----------------------------------------------------------------------------------|--------------------------------------------------------|--------------|--------------------------------------|
|  | <b>Product Information</b><br><b>NIS50-32-160/0.75</b> | Manufacturer | CNP                                  |
|                                                                                  |                                                        | Address      | Yuhang District, Hangzhou, Zhejiang, |
| Project Name                                                                     |                                                        | Contact      | 86-571-88637351                      |
|                                                                                  |                                                        | Date         | 2022/03/06                           |
| Item NO                                                                          |                                                        | Client Name  | DPA                                  |
|                                                                                  |                                                        | Client Addr. |                                      |
|                                                                                  |                                                        | Contacts     | Alireza                              |
|                                                                                  |                                                        | Contact      |                                      |

|          |            |
|----------|------------|
| Part NO. | 1100054467 |
|----------|------------|

| Product Picture                                                                   | Note                                                                                                                                                                                    |
|-----------------------------------------------------------------------------------|-----------------------------------------------------------------------------------------------------------------------------------------------------------------------------------------|
|  | <p>Non-prime single stage horizontal end suction centrifugal pump, axial inlet and radial outlet, back pull out design, easy maintenance without removing pumpbody and pipe system.</p> |

|                            |                                            |
|----------------------------|--------------------------------------------|
| <b>technology</b>          |                                            |
| Pump rotator speed         | 1450                                       |
| <b>Material</b>            |                                            |
| Impeller                   | HT200                                      |
| Pump body                  | QT500-7                                    |
| Rubber code                | P                                          |
| Material Code              | H                                          |
| <b>Installation</b>        |                                            |
| Maximum Operation Pressure | 16Bar                                      |
| Maximum Inlet Pressure     | 6Bar                                       |
| <b>Medium</b>              |                                            |
| Medium Temperature         | -15~110                                    |
| <b>Structure dimension</b> |                                            |
| Inlet & outlet size types  | DN                                         |
| Inlet Bore                 | 50                                         |
| Outlet Diameter            | 32                                         |
| Rotation Direction         | Anti-clockwise rotation viewing from inlet |
| <b>Motor</b>               |                                            |
| Number of Motor Phase      | Three Phase                                |
| Protection Class           | IP55                                       |
| Insulation Class           | F                                          |
| Motor Power                | 0.75                                       |
| Power Frequency            | 50HZ                                       |
| Rated Voltage (V)          | 220/380V                                   |
| Rated Current (A)          | 3.3/1.9                                    |
| Energy Efficiency Level    | IE3                                        |
| <b>Seal</b>                |                                            |
| Mechanical Seal            | NISO-33/BSE4                               |
| <b>Others</b>              |                                            |
| Weight (kg)                | 45                                         |

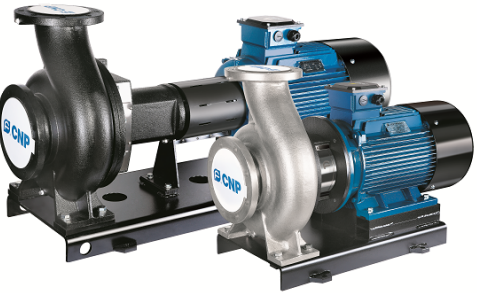

# Performance Curve NIS50-32-160/0.75

|              |                                      |
|--------------|--------------------------------------|
| Manufacturer | CNP                                  |
| Address      | Yuhang District, Hangzhou, Zhejiang, |
| Contact      | 86-571-88637351                      |
| Date         | 2022/03/06                           |
| Client Name  | DPA                                  |
| Client Addr. |                                      |
| Contacts     | Alireza                              |
| Contact      |                                      |

Project Name

Item NO

The hydraulic performance curve have been tested with Clean Water at 20°C, density 1000kg/m<sup>3</sup>, and at 1bar atmospheric pressure. ISO99062012 Grade 3B

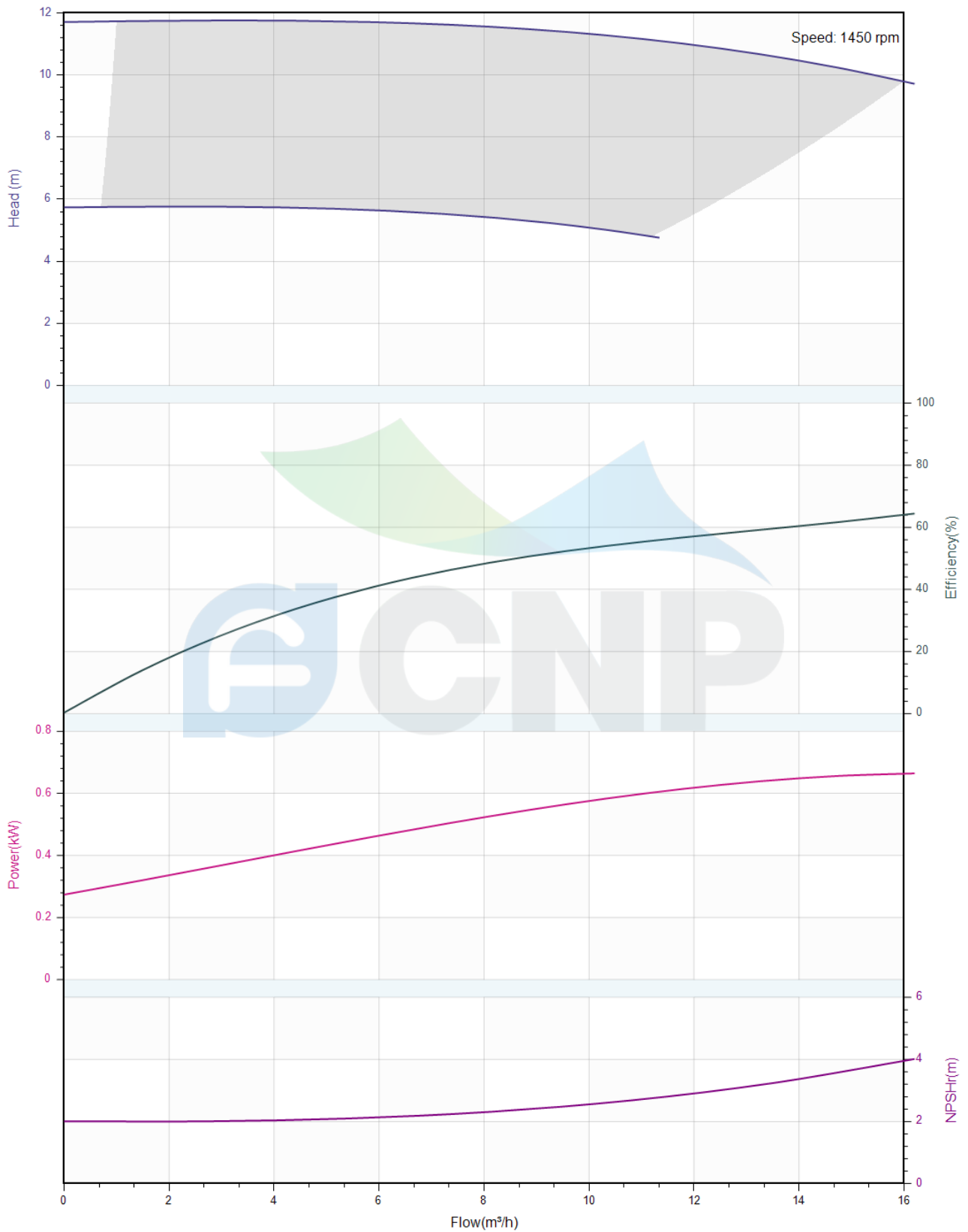



### Pump Technical Parameters NIS50-32-160/0.75

|              |                                      |
|--------------|--------------------------------------|
| Manufacturer | CNP                                  |
| Address      | Yuhang District, Hangzhou, Zhejiang, |
| Contact      | 86-571-88637351                      |
| Date         | 2022/03/06                           |
| Client Name  | DPA                                  |
| Client Addr. |                                      |
| Contacts     | Alireza                              |
| Contact      |                                      |

#### Rated parameters

|                                |                   |
|--------------------------------|-------------------|
| Pump model                     | NIS50-32-160/0.75 |
| Part NO.                       | 1100054467        |
| Rated flow (m <sup>3</sup> /h) | 6.3               |
| Rated head (m)                 | 11                |
| Rated efficiency (%)           | 41                |
| Power (kW)                     | 0.46              |
| NPSHr (m)                      | 2                 |
| Speed (rpm)                    | 1450              |
| Max impeller diameter (mm)     | 183               |

#### Medium

|                                     |             |
|-------------------------------------|-------------|
| Pumped medium                       | Clean Water |
| Working temperature (°C)            | 20          |
| Medium density (kg/m <sup>3</sup> ) | 1000        |
| Viscosity (mm <sup>2</sup> /s)      | 1           |

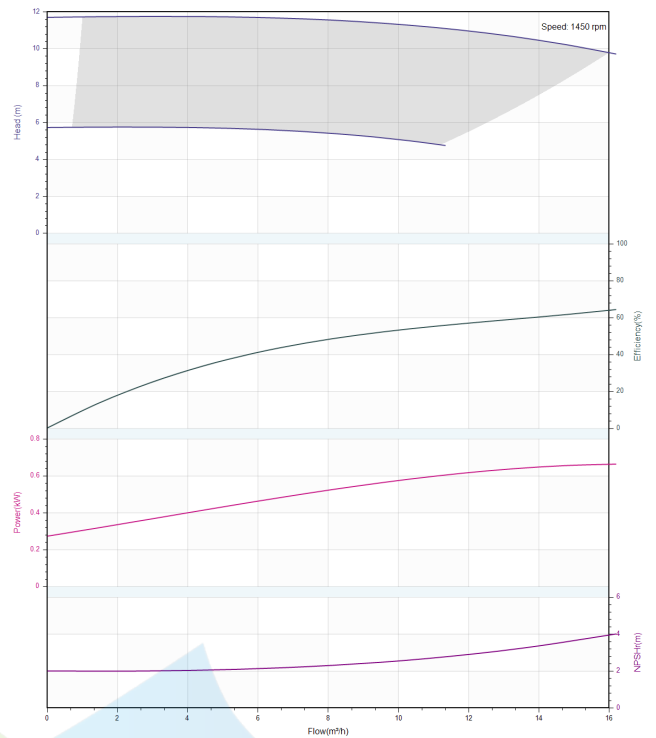

|                                                                                  |                                                      |              |                                      |
|----------------------------------------------------------------------------------|------------------------------------------------------|--------------|--------------------------------------|
|  | <b>Structure picture</b><br><b>NIS50-32-160/0.75</b> | Manufacturer | CNP                                  |
|                                                                                  |                                                      | Address      | Yuhang District, Hangzhou, Zhejiang, |
| Project Name                                                                     |                                                      | Contact      | 86-571-88637351                      |
|                                                                                  |                                                      | Date         | 2022/03/06                           |
| Item NO                                                                          |                                                      | Client Name  | DPA                                  |
|                                                                                  |                                                      | Client Addr. |                                      |
|                                                                                  |                                                      | Contacts     | Alireza                              |
|                                                                                  |                                                      | Contact      |                                      |

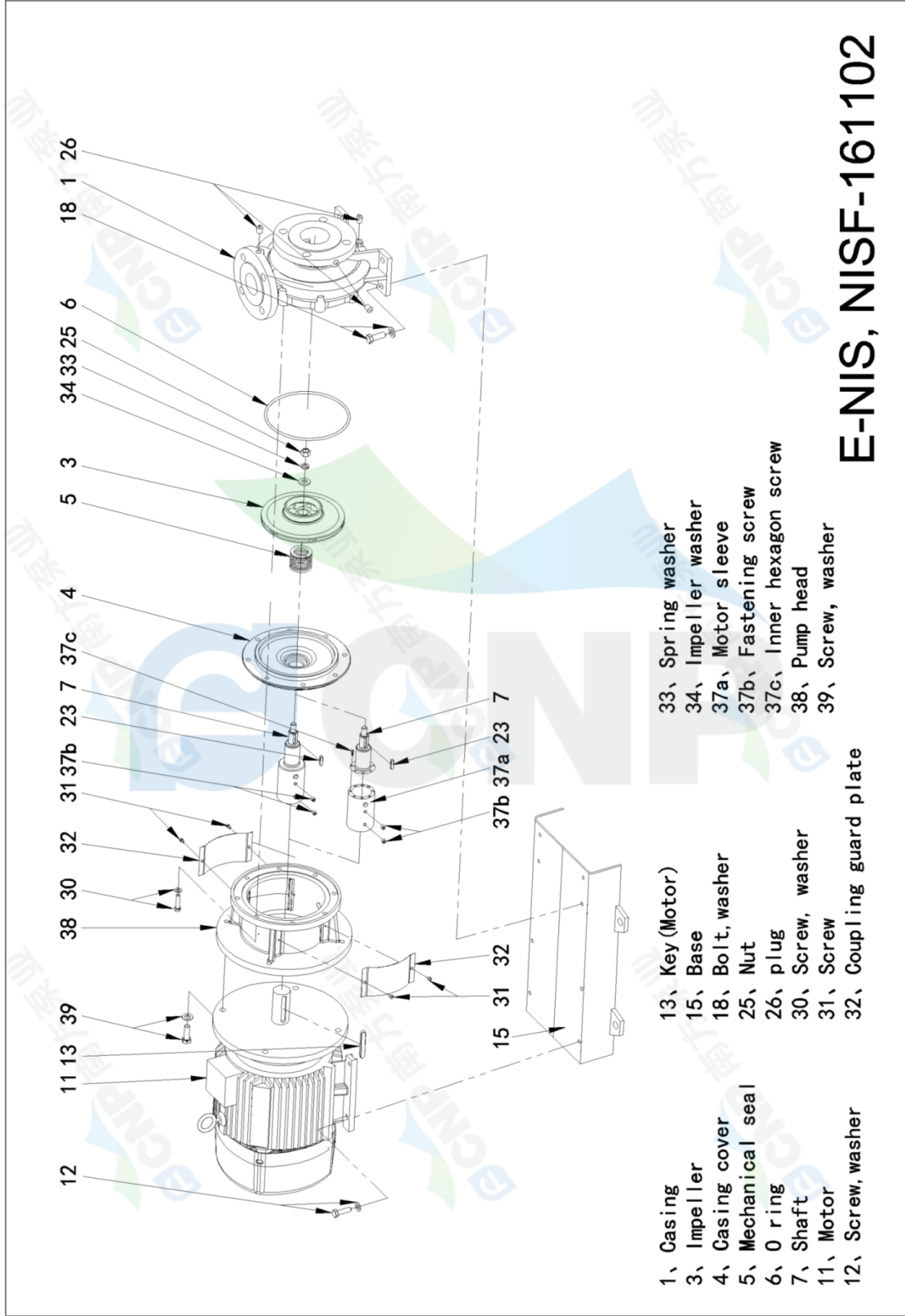



# Dimension Drawing NIS50-32-160/0.75

|              |                                      |
|--------------|--------------------------------------|
| Manufacturer | CNP                                  |
| Address      | Yuhang District, Hangzhou, Zhejiang, |
| Contact      | 86-571-88637351                      |
| Date         | 2022/03/06                           |
| Client Name  | DPA                                  |
| Client Addr. |                                      |
| Contacts     | Alireza                              |
| Contact      |                                      |

Project Name

Item NO

NIS(F) 50-32-160/0.55, 50-32-160/0.75

